

BIKE	KAWASAKI Z1000	PART NO.	EKA-79
YEAR	2007 - 2009	FIT KITS	OVAL Z039.11234 // ROUND Z039.10234
NOTES	Where not supplied use original fittings	DB-Killer	2 x SCEXDBK12 - (Type B)

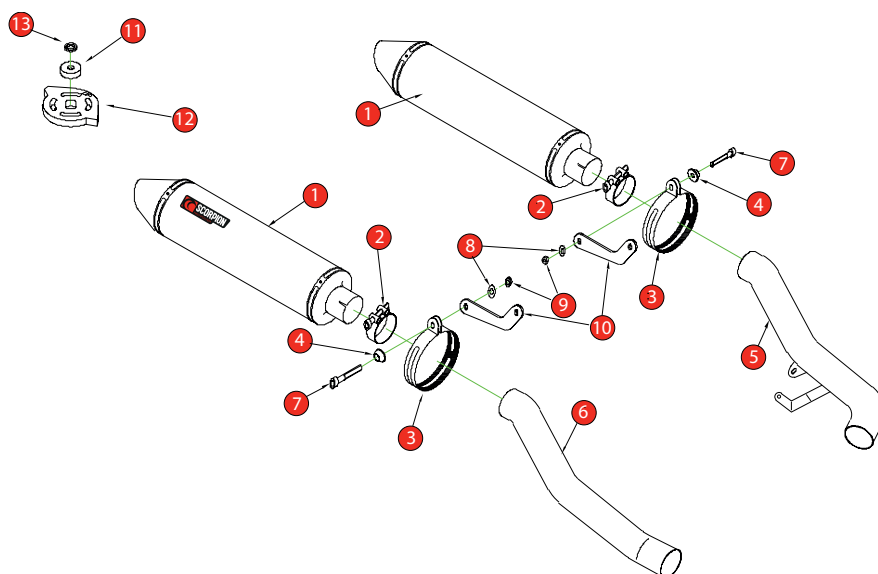

- 1 2 x 450mm Silencers ESC 118
- 2 2 x 51-55mm Band Clamps (Z016.10002)
- 3 2 x Composite Straps (R-Z038.10090)(O-Z038.10088)
- 4 2 x Aluminium Bolt Finishers (Z026.20068)
- 5 Connecting Pipe CP 422
- 6 Connecting Pipe CP 423
- 7 2 x M8 x 25mm Cap Head Bolts (Z017.10073)
- 8 2 x M8 x 17mm Washers (Z017.10831)

- 9 2 x M8 Nyloc Nuts (Z017.10062)
- 10 2 x Mounting Brackets (Z015.20931)
- 11 Aluminium Collar (Z026.20045)
- 12 Replacement Servo Wheel (Z007.10955)
- 13 M6 Split Washer (Z017.10027)
- 14 Bump Stop Kit (Z017.10010)

**NOTE:** ENSURE SCORPION SYSTEM IS CLEAR OF MOVING PARTS AND ALL ORIGINAL FUNCTIONS WORK CORRECTLY.

E-MARK PIPE	KA-79R <a href="#">E4</a> 2296 <a href="#">(5)</a> KA-79O <a href="#">E4</a> 2326 <a href="#">(6)</a>
E-MARK ROUND	KA-79R <a href="#">E4</a> 2296 <a href="#">(9)</a>
E-MARK OVAL	KA-79O <a href="#">E4</a> 2326 <a href="#">(9)</a>
ISSUE NO.	07
DATE	18/10/2018
AUTHORISED	J.Harkin
CHECKED	

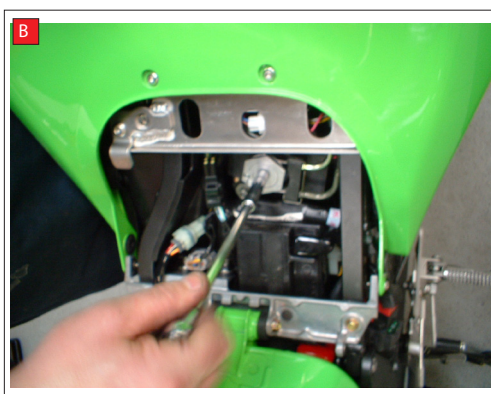
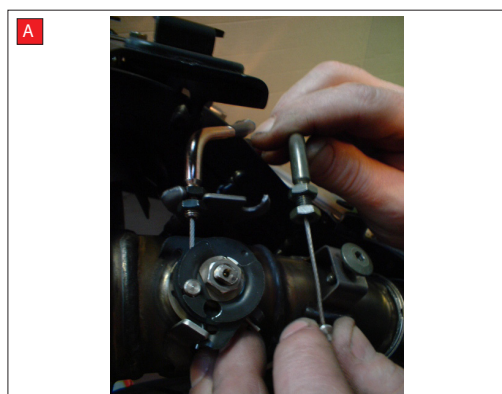

A) Disconnect cables on exhaust valve and leave loose.

B) To disconnect cables at the servo box end, you have to remove the hexagonal wheel, without turning it's shaft.  
Remove bolt in centre of hexagonal wheel using an 8mm socket. Support wheel if tight.

C) Remove hexagonal wheel from shaft, retaining OE bolt. Do not turn shaft.

Remove spring clip retaining cables and completely remove the cables



D) The replacement wheel comes with an aluminium collar & spring washer that is secured in place with OE bolt – TIGHTEN TO 5ft/lb USING A TORQUE WRENCH.



Box: PLOCK 1

BIKE	KAWASAKI Z1000	PART NO.	EKA - 79
YEAR	2007 - ON	FIT KITS	OVAL Z039.11234 // ROUND Z039.10234
NOTES	Where not supplied use original fittings	FEATURES	

CONTINUED FROM OVERLEAF:



The replacement wheel must be fitted with the etched letters "UP"

E) RIGHT  
F) WRONG