



EVOTECH®
P E R F O R M A N C E

www.evotech-performance.com

Triumph Rocket
Ultimate Addons Sat Nav Mount

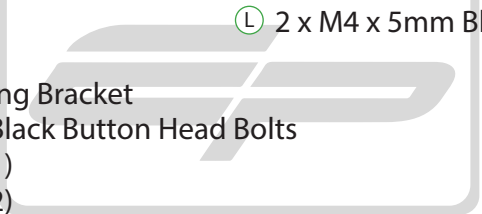

- 
- (A) 1 x Main Plate
 - (B) 1 x Pivot Plate
 - (C) 1 x Sub Mounting Bracket
 - (D) 2 x M5 x 8mm Black Button Head Bolts
 - (E) 2 x P-clips (No.1)
 - (F) 2 x P-clips (No.2)
 - (G) 2 x P-clips (No.3)
 - (H) 2 x P-clips (No.4)
 - (I) 2 x Lobe Screw
 - (J) 2 x M5 Black Washer
 - (K) 2 x Locking Washer
 - (L) 2 x M4 x 5mm Black Button Head Bolts
- Sub Kit
- (AA) 2 x M5 x 16mm Flange Bolt
 - (BB) 1 x M5 x 20mm Flange Bolt
- PERFORMANCE

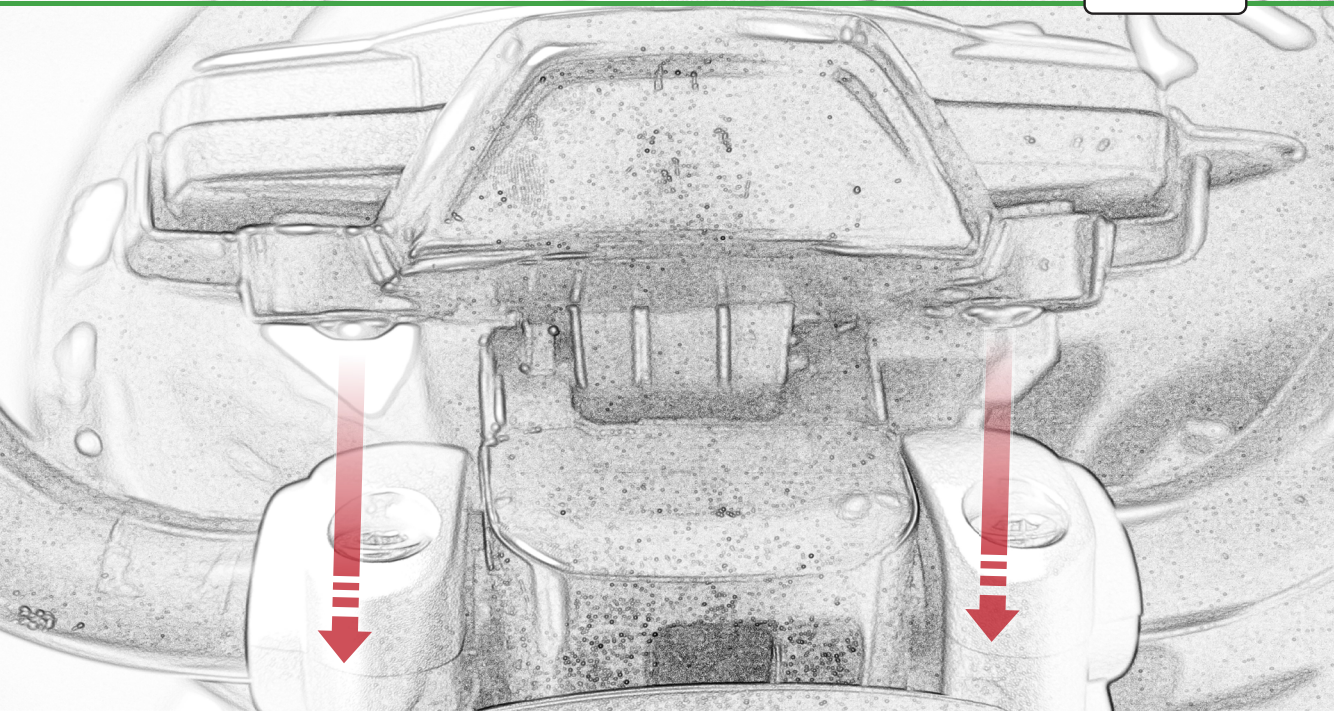

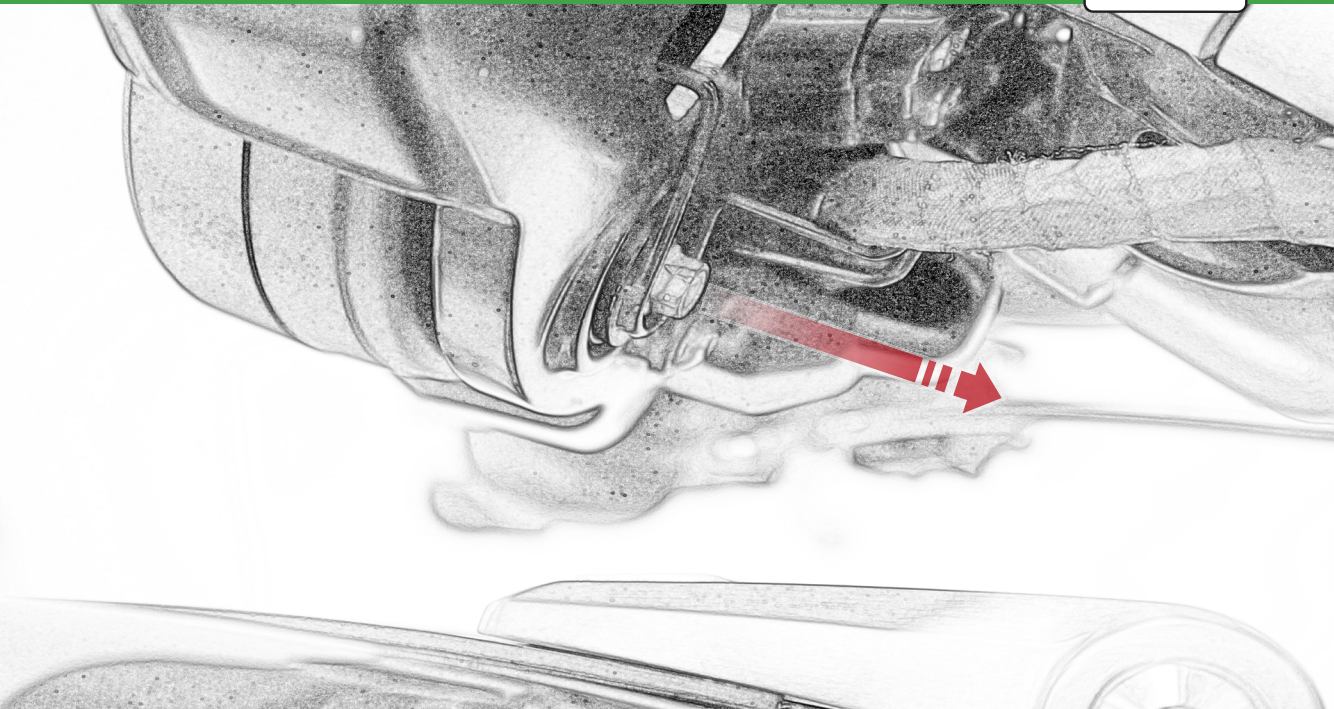

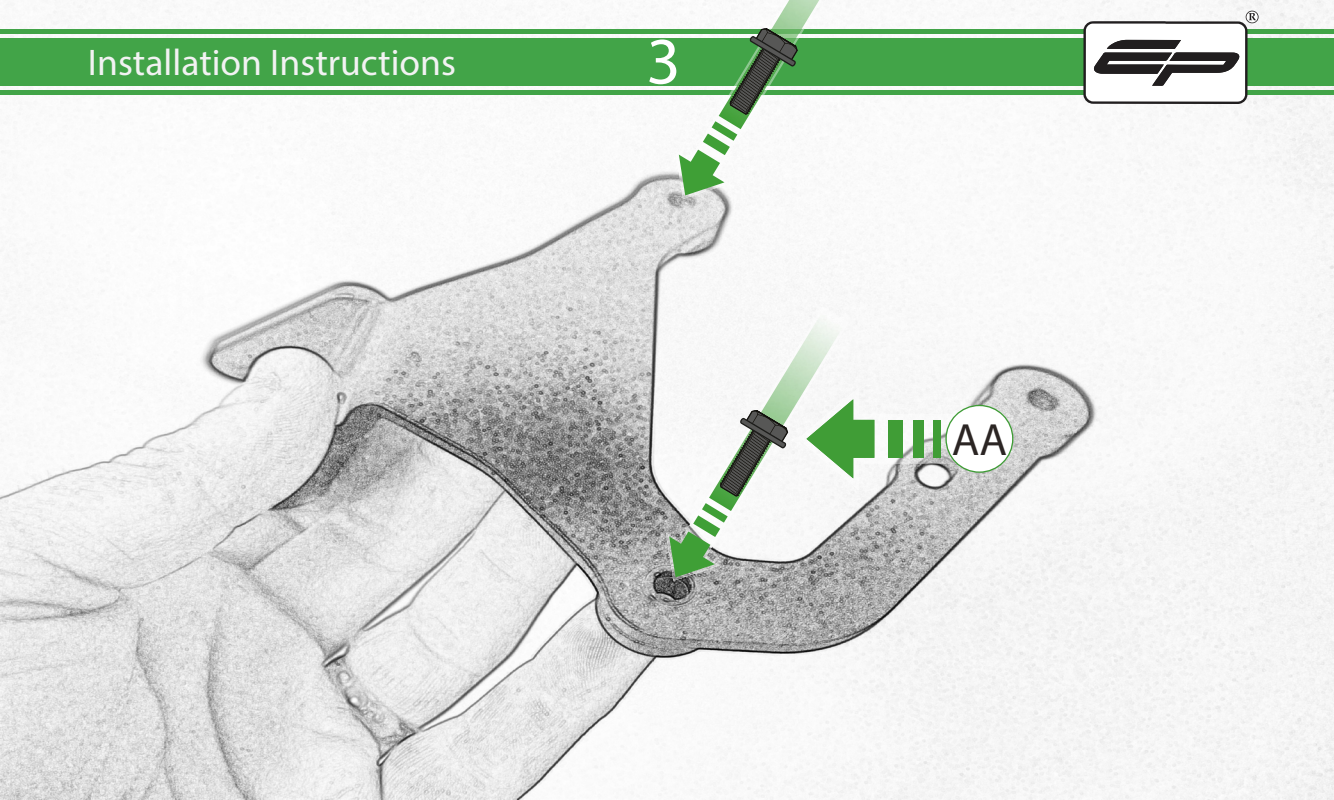

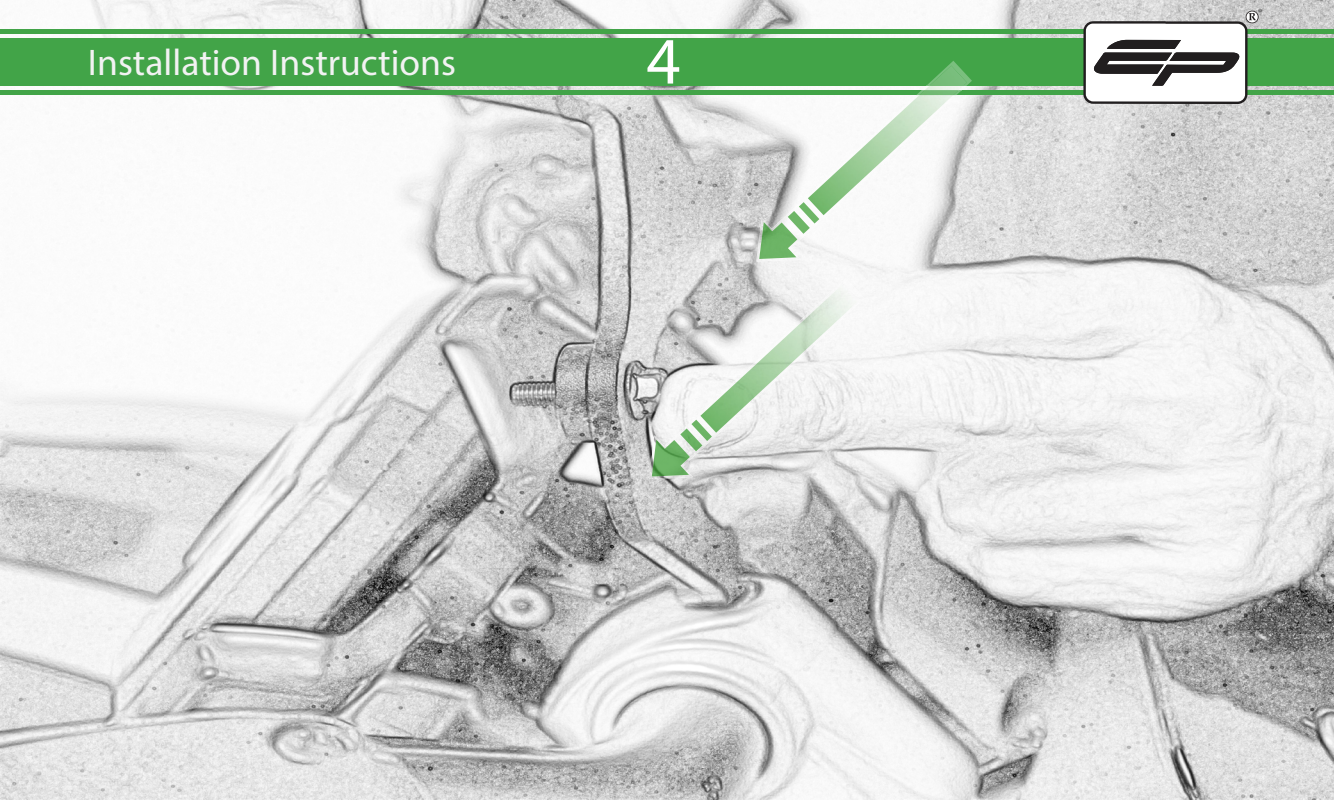

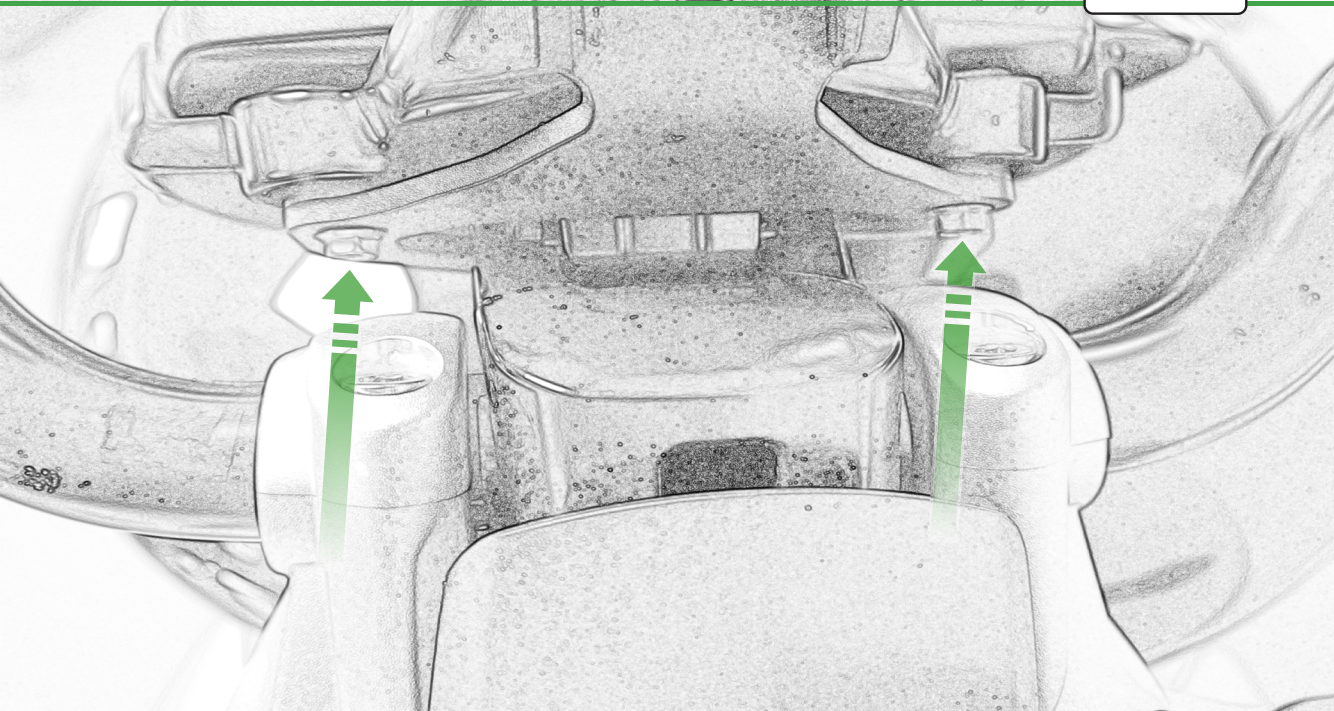

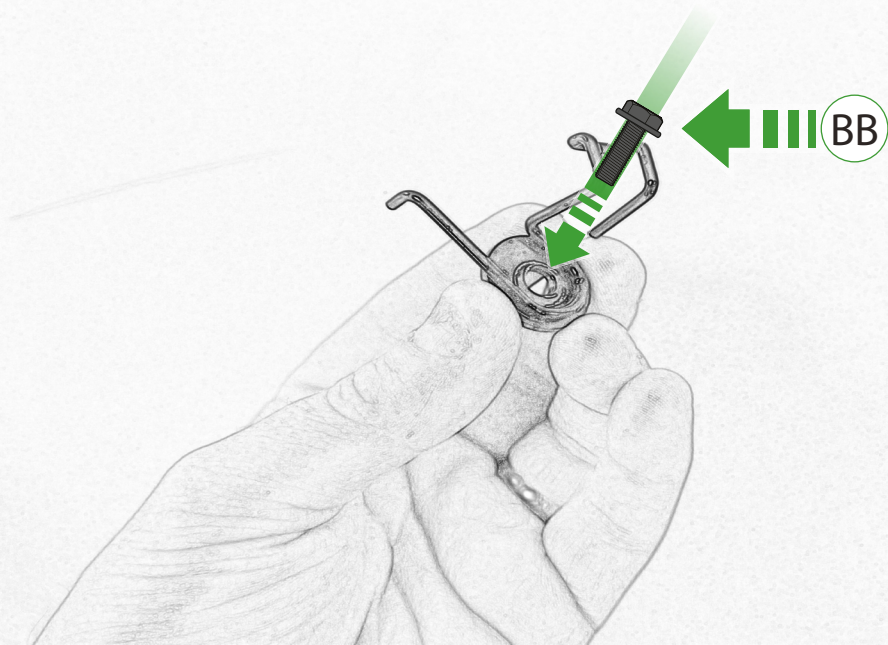

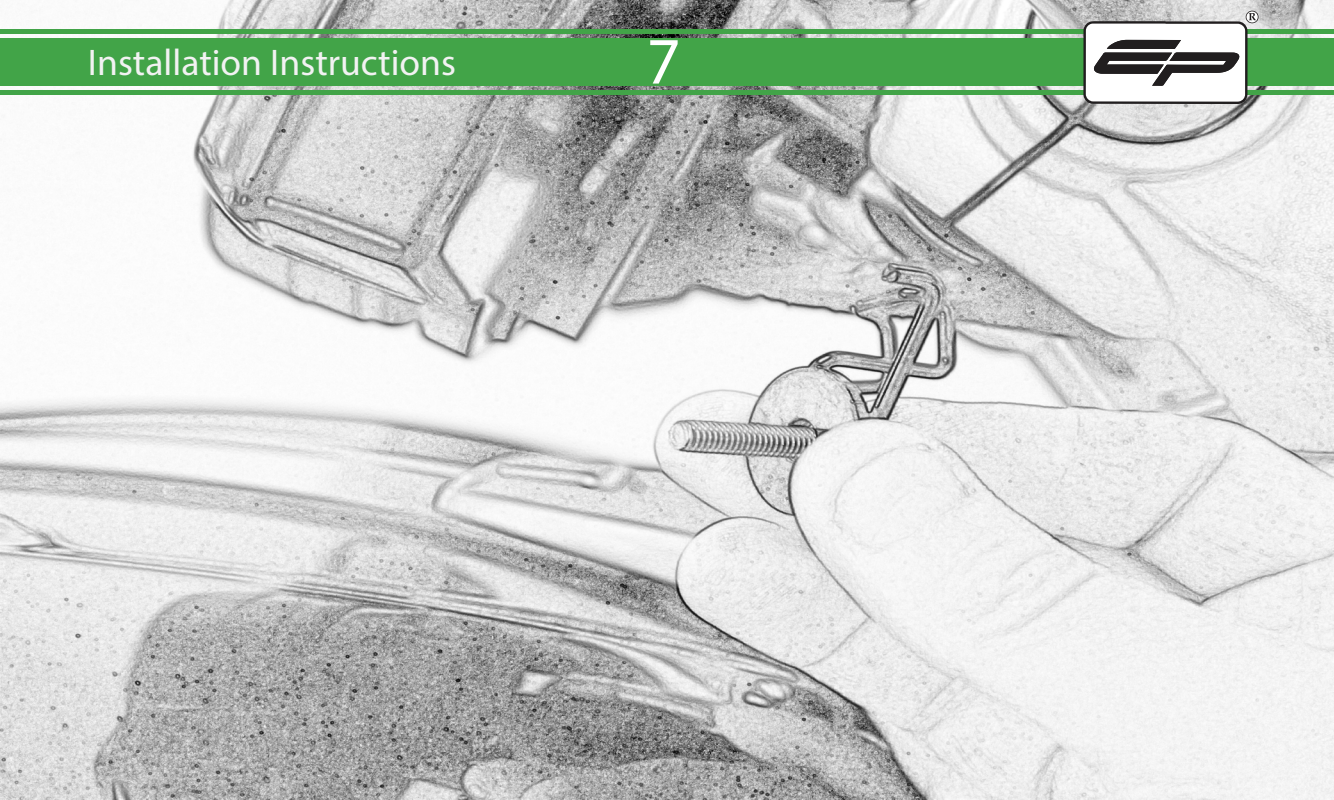

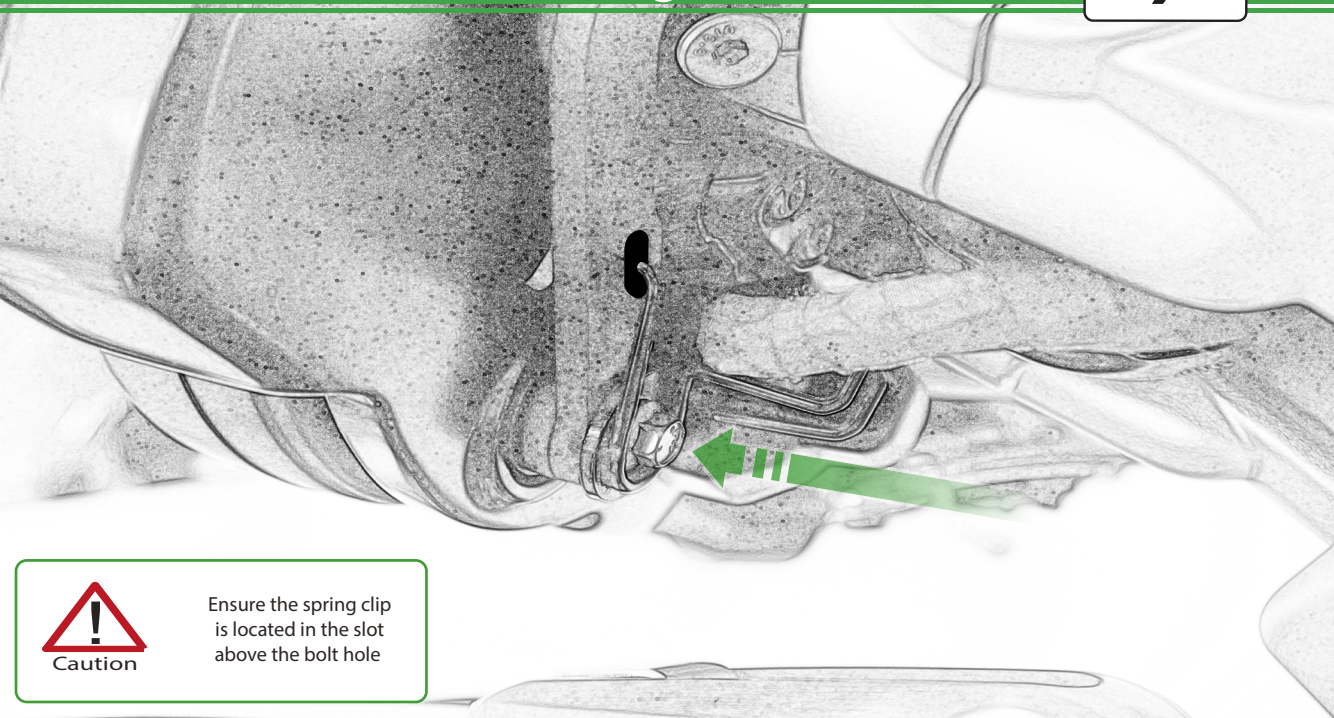

Caution

Ensure the spring clip
is located in the slot
above the bolt hole

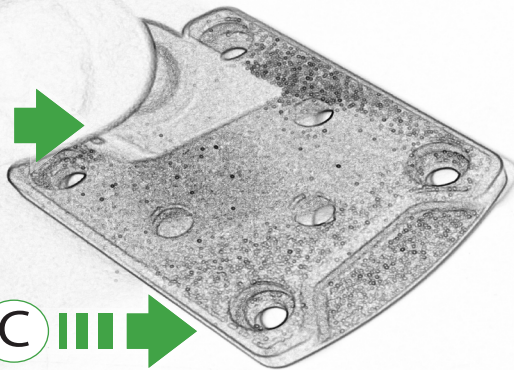

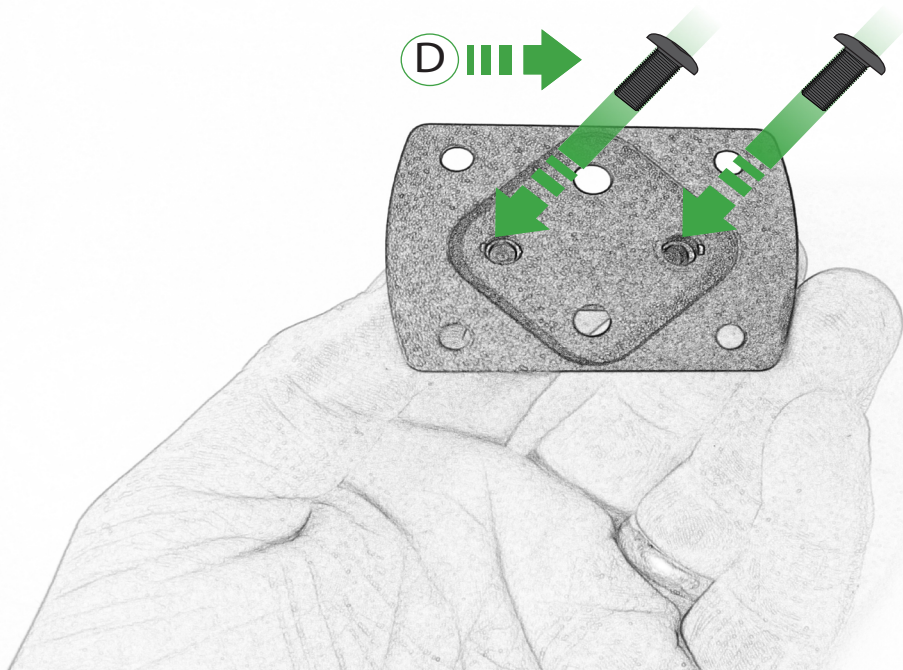

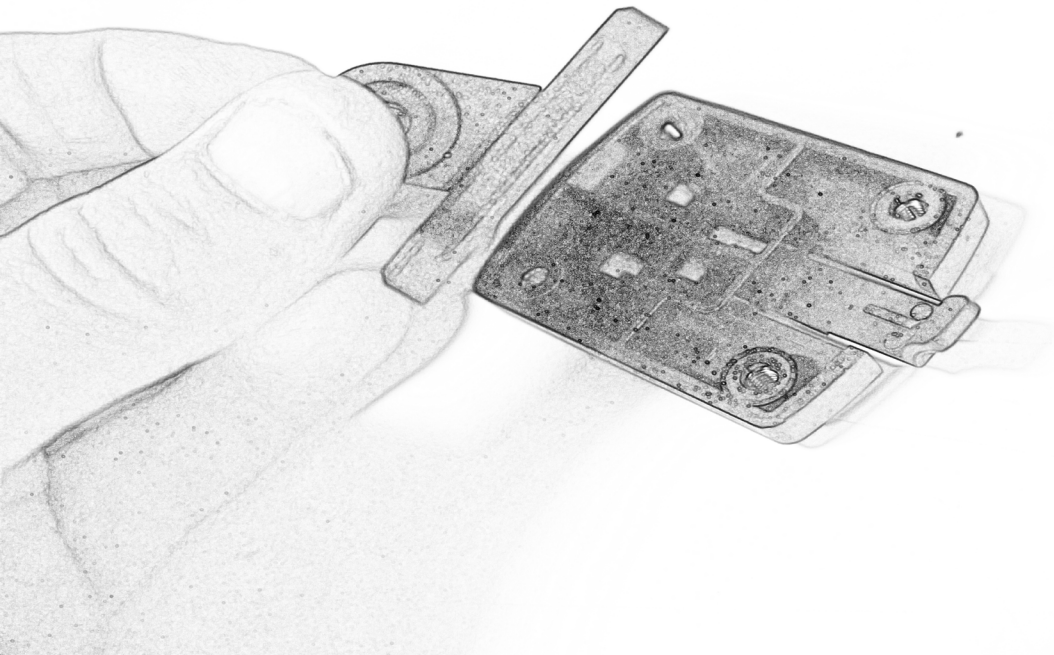



OEM PART

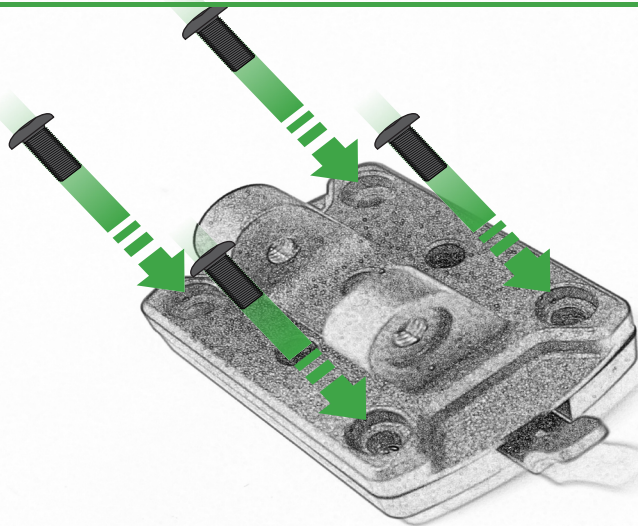

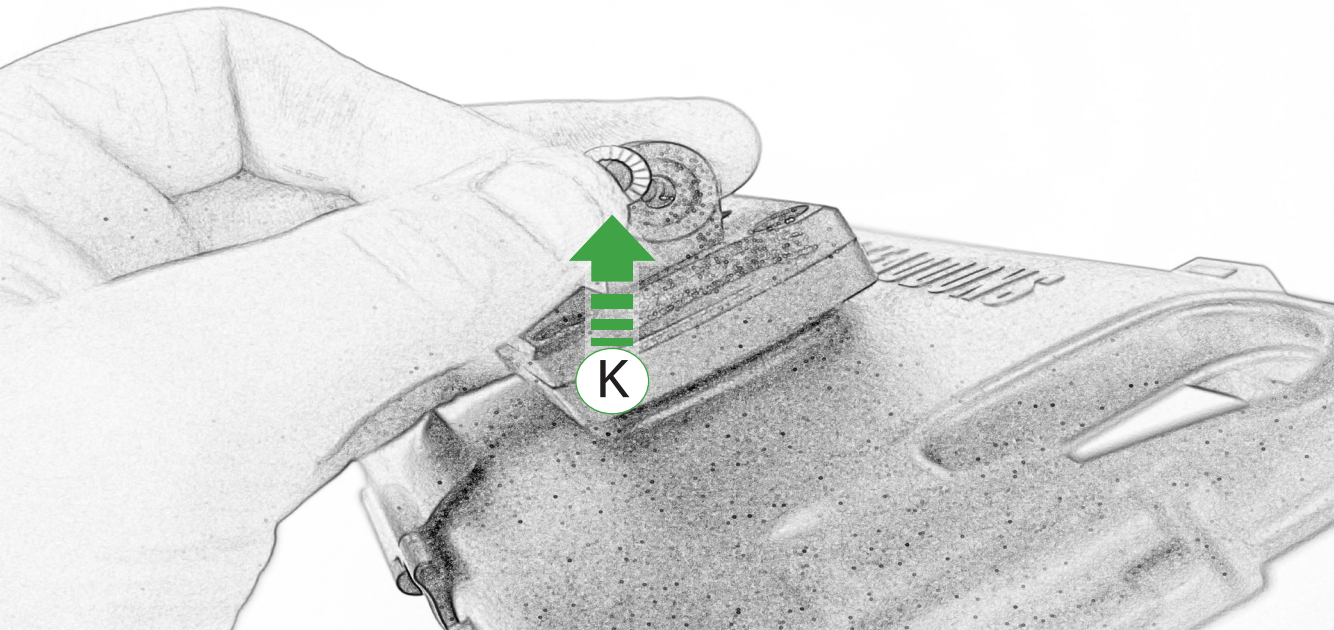

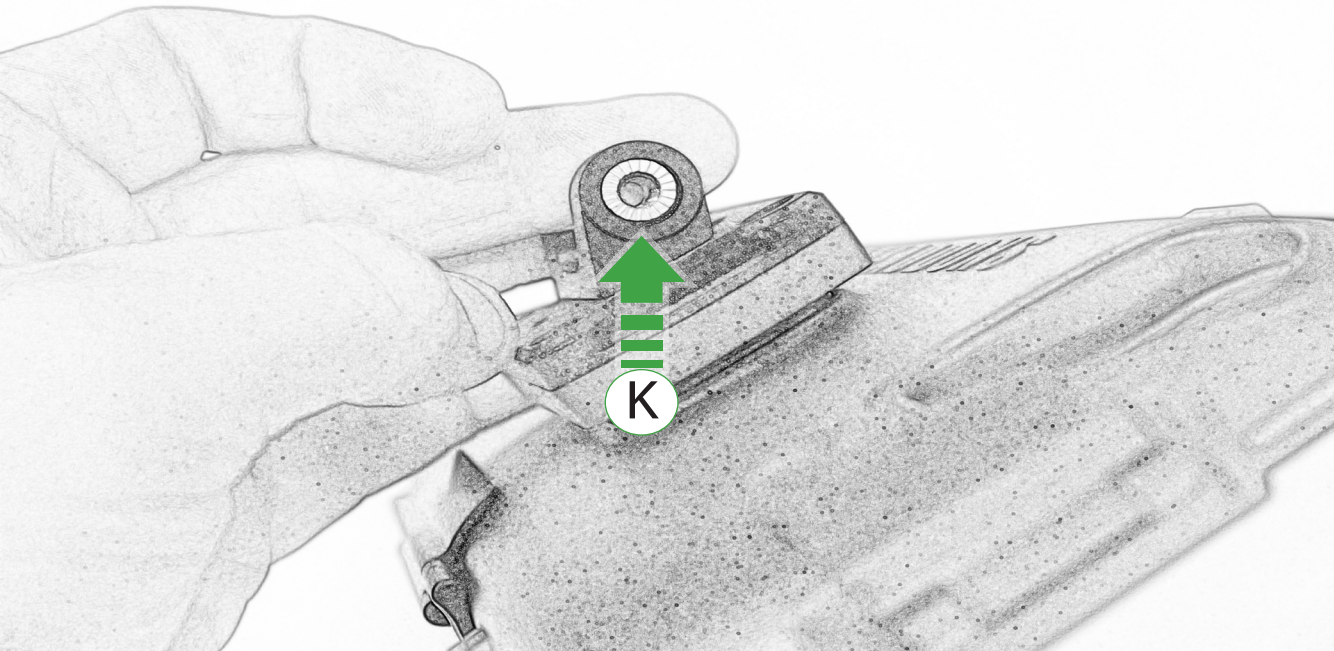

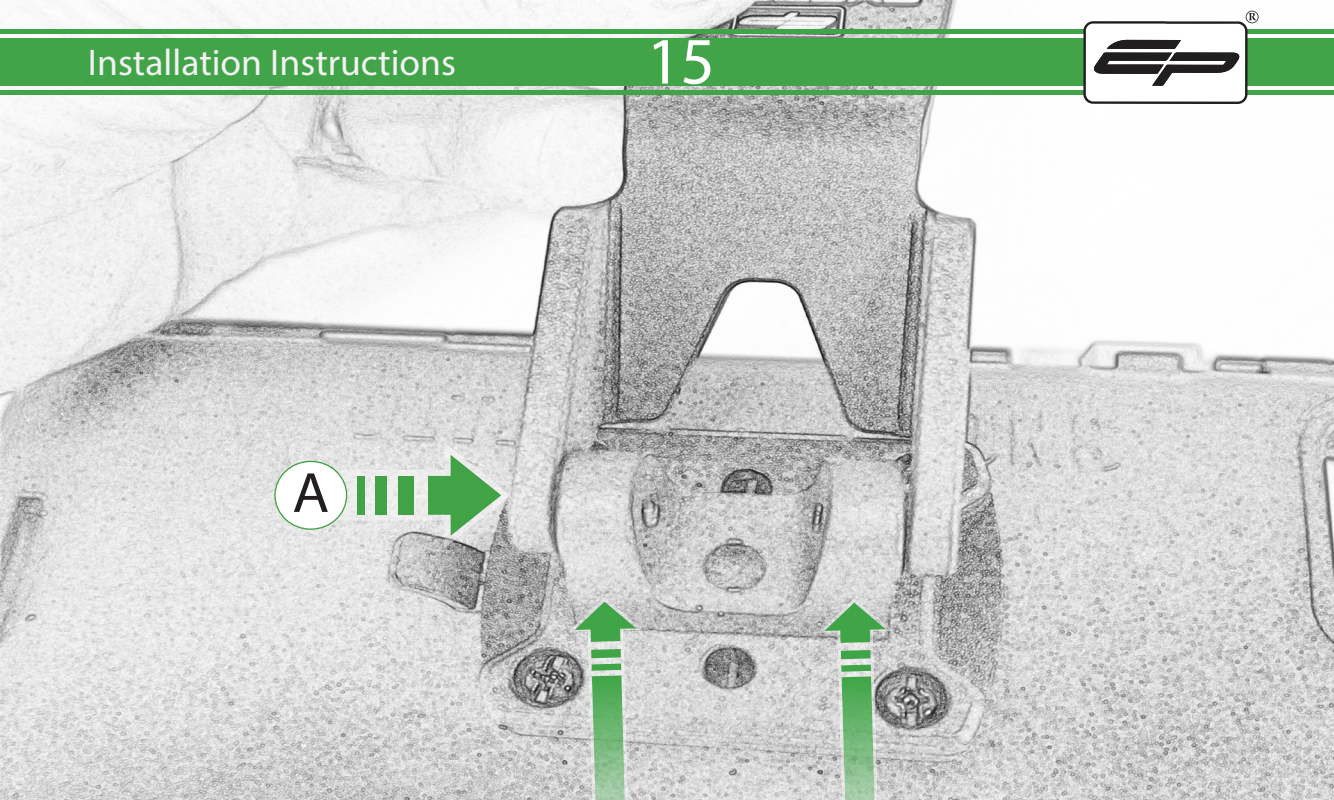

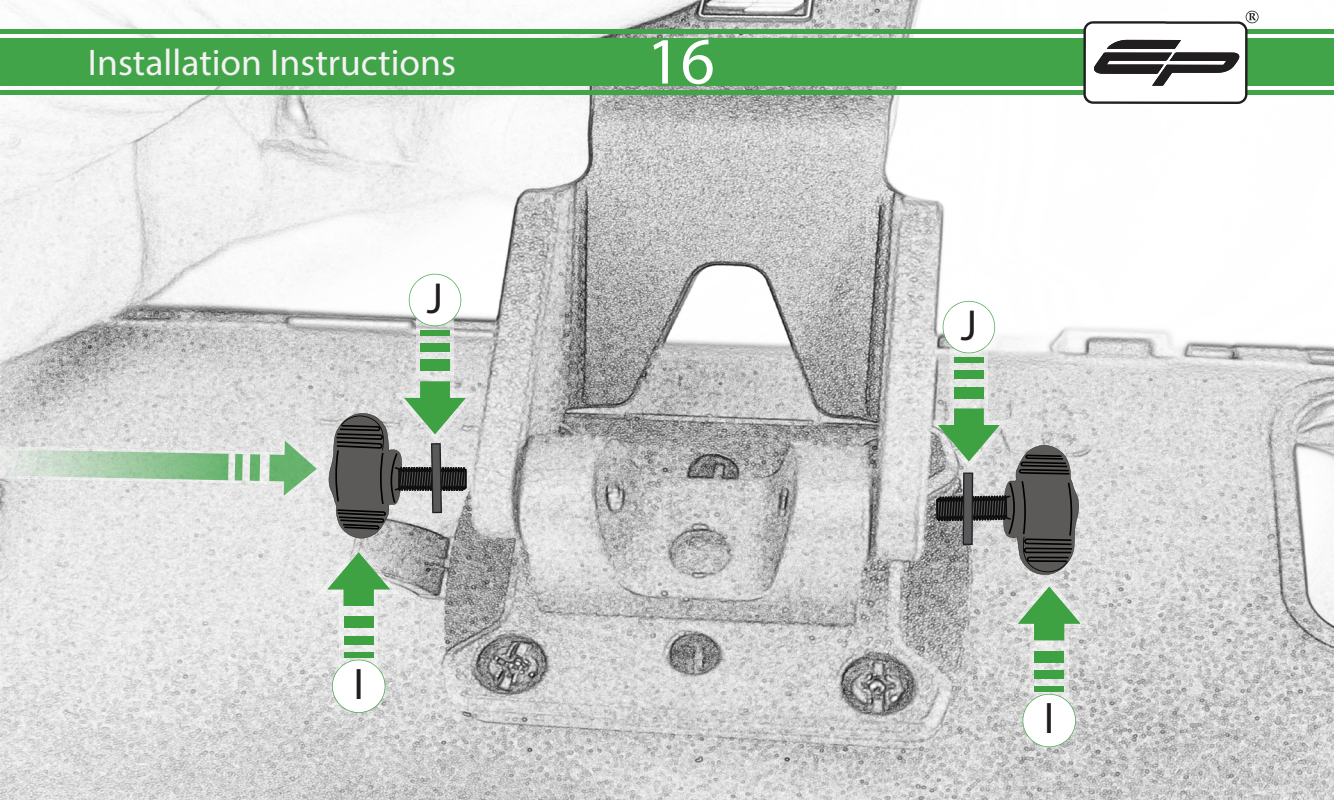



ESSENTIAL CHECKS

It is recommended that periodic inspections are made to ensure that all bolts are tightened to the specified torque settings.

Some smartphone models may also require an anti-vibration mount or dampener to further reduce vibration and help with image stabilisation.

It is the rider's responsibility to ensure that this is fitted correctly before use.

P E R F O R M A N C E



EVOTECH®
P E R F O R M A N C E

www.evotech-performance.com