



## 09005 Suzuki DL1050 Headlight Guard Instructions

Kit Includes:

1X	Clear Guard	C09005
2X	Brackets	CFK09005A & CFK09005B
2X	M8 X 40mm Bolts	CBOL0305
4X	M5 X 16mm Bolts	CBOL2168
2X	Spacers	CSPA0023
4X	Rubber Anchor Nuts	CNUT0156
8X	Washers	CWAS0230

- Assemble the Pyramid headlight guard as shown in the diagram below. Don't over tighten.
- Remove the two bolts on each side of the headlight.
- Fit the Pyramid headlight guard using the M8 X 40mm bolts & spacers on each side.
- Start by fitting loosely on each side. Once happy with the positioning, tighten the side mountings.

**Note: The slotted mounting holes in the brackets allow for any small adjustments backwards and forwards.**

**Check fixings periodically.**

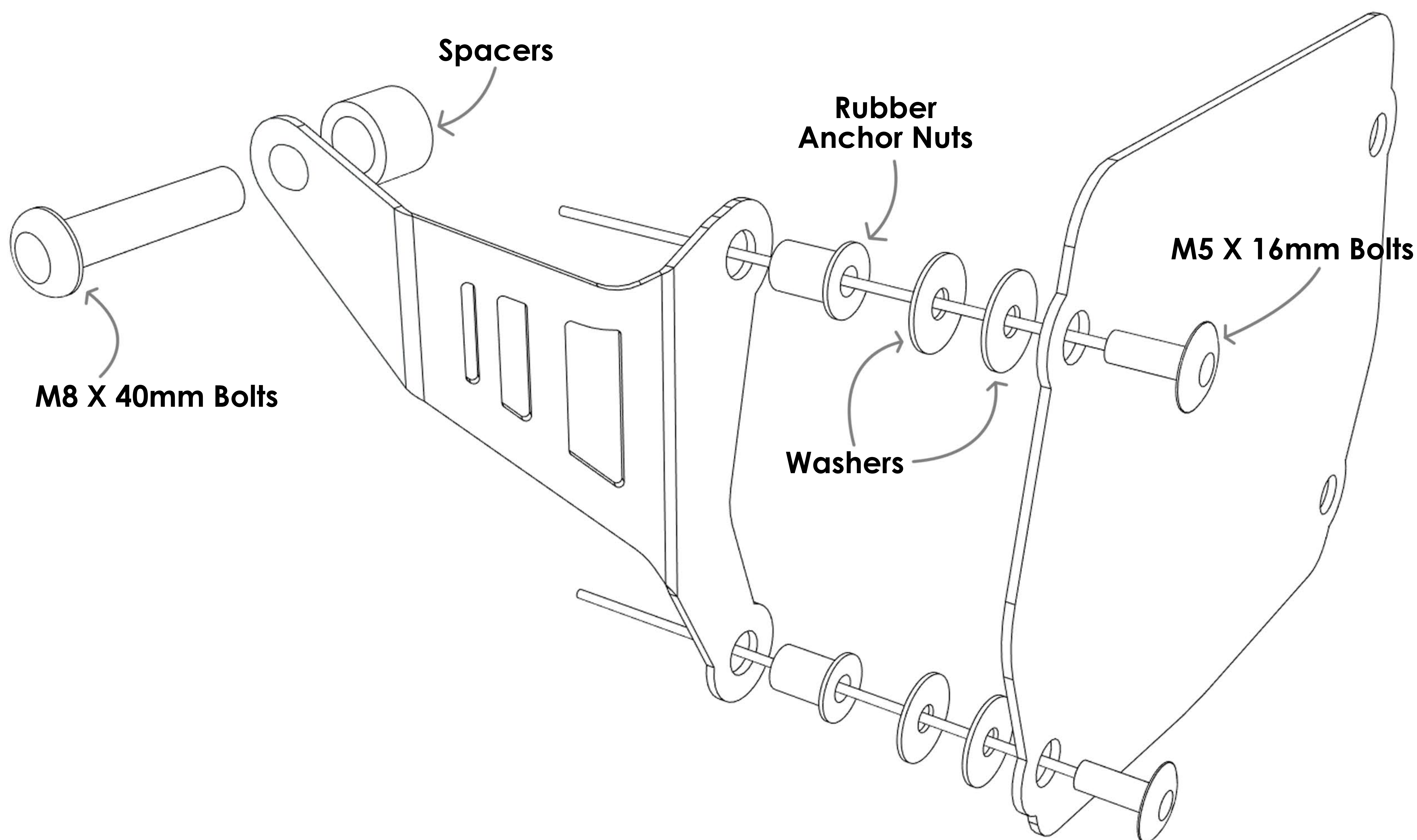

sales@pyramid-plastics.co.uk  
+44 (0)1427 677990  
www.pyramid-plastics.co.uk

Follow us on social media and feel free to leave us a review!

