



EVOTECH®
P E R F O R M A N C E

www.evotech-performance.com

Triumph Scrambler 1200 XC / XE Tail Tidy
Installation Instructions



Kit Contents PRN014766

- | | |
|----------------------------------|-----------------------------------|
| (A) 1 x EP Connector Type 10 | (M) 2 x M6 x 25 Button Head Bolts |
| (B) 1 x EP Connector Type 25 | (N) 2 x M6 x 30 Button Head Bolts |
| (C) 1 x Led Number Plate Light | (O) 2 x M4 x 12 Button Head Bolts |
| (D) 1 x Neoprene | (P) 2 x M4 x 25 Screws |
| (E) 1 x Wire Heat Seal | (Q) 2 x M4 Flange Nuts |
| (F) 1 x Number Plate Light Block | (R) 4 x M6 x 20 Button Head Bolts |
| (G) 1 x Undertray | (S) 4 x M6 Flange Nut |
| (H) 1 x Main Bracket | |
| (I) 1 x Light Housing | |
| (J) 1 x LED Rear Light | |
| (K) 2 x Short Spacer | |
| (L) 2 x Longer Spacer | |

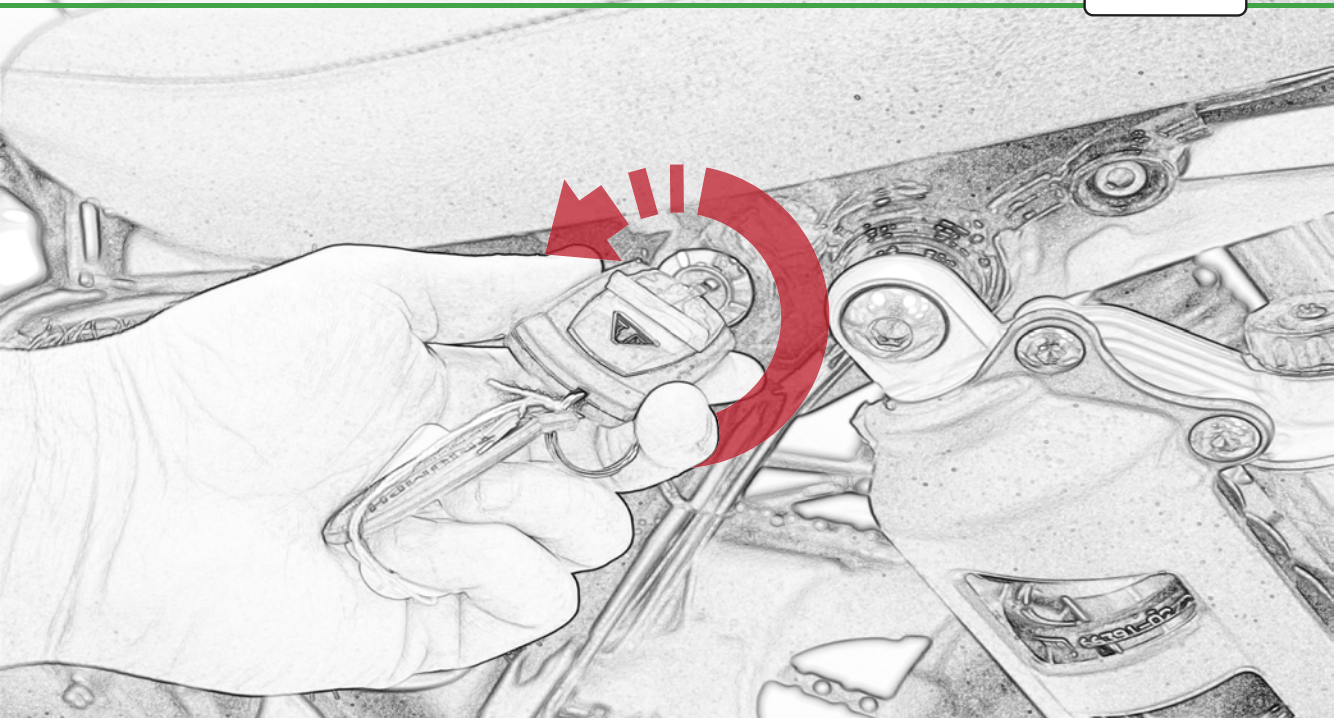

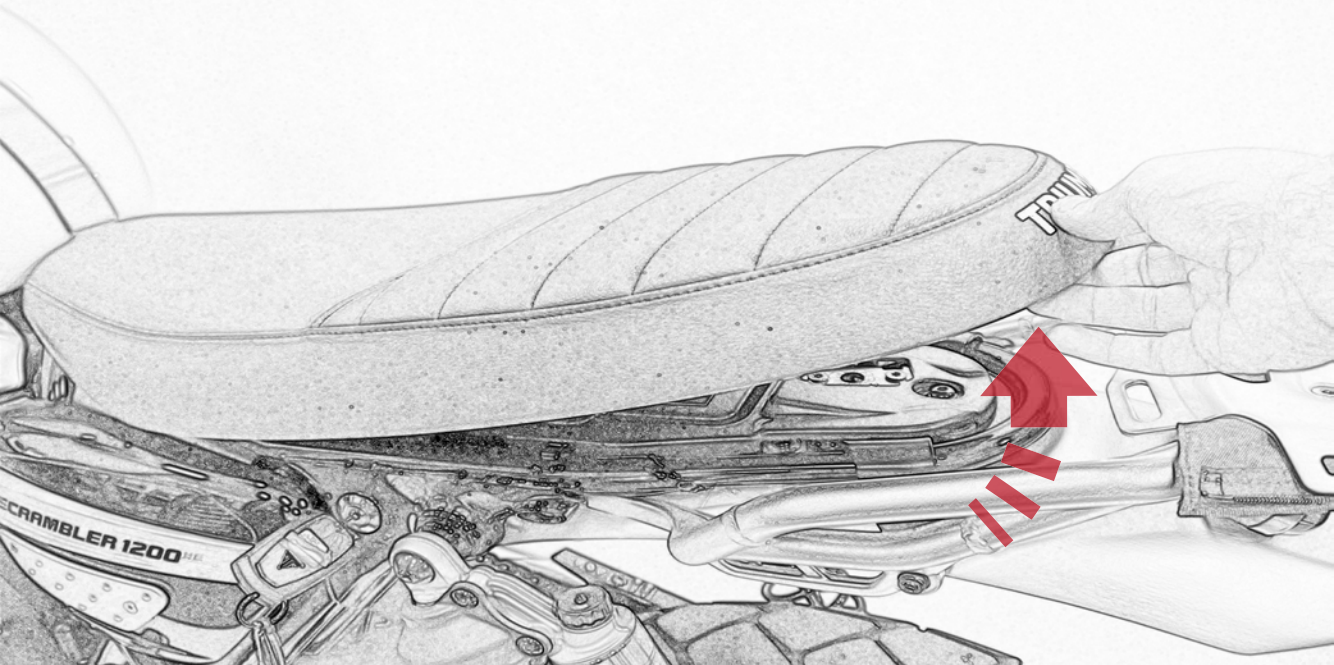

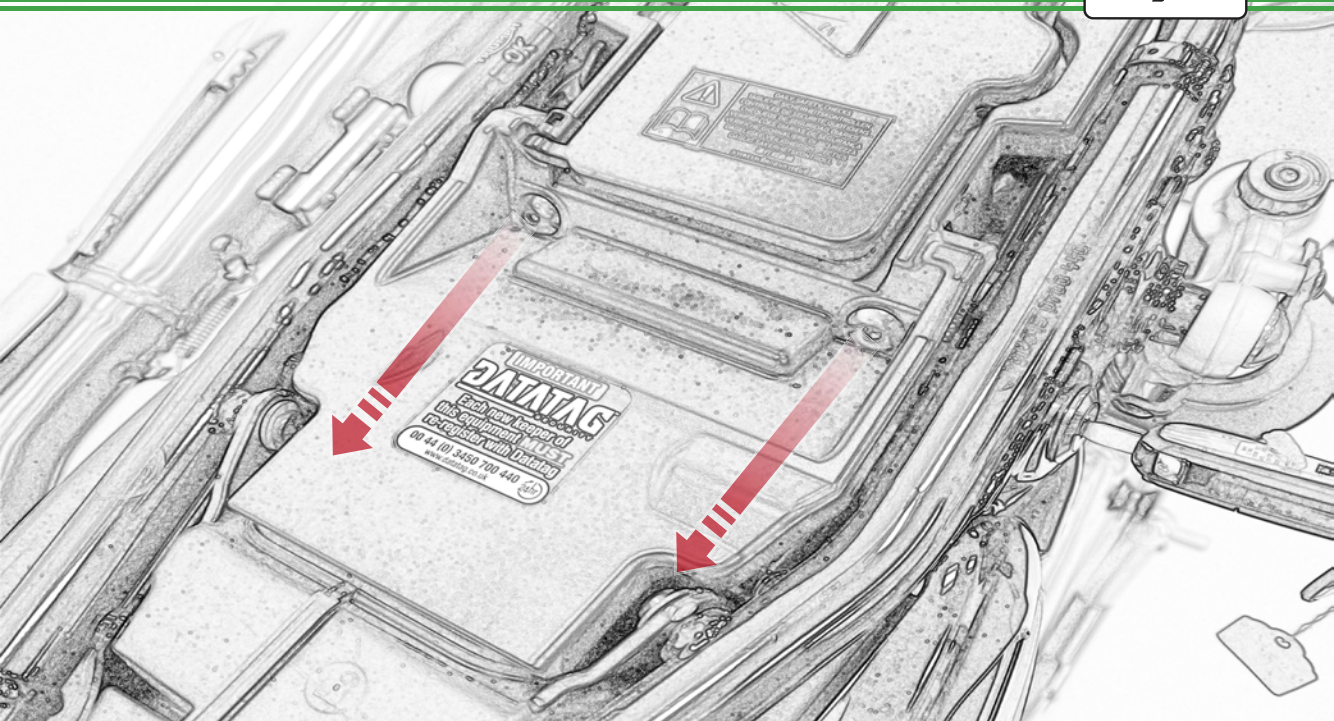

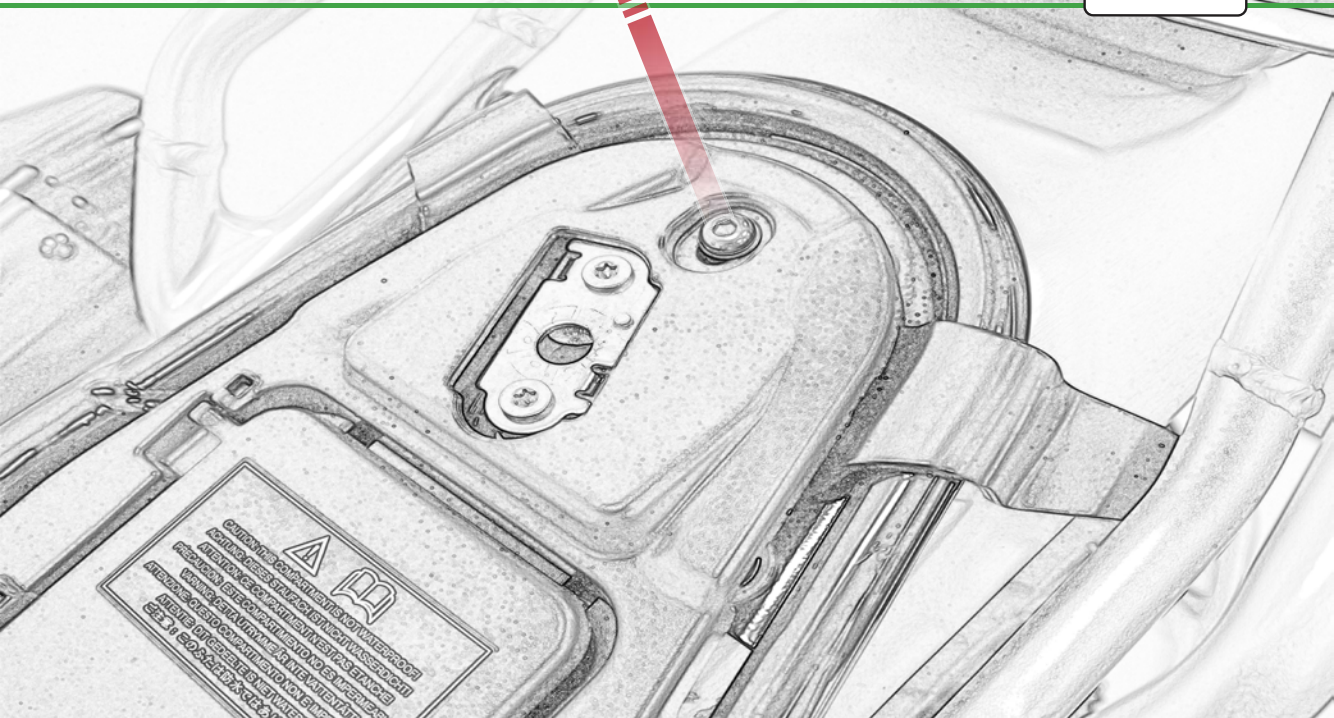

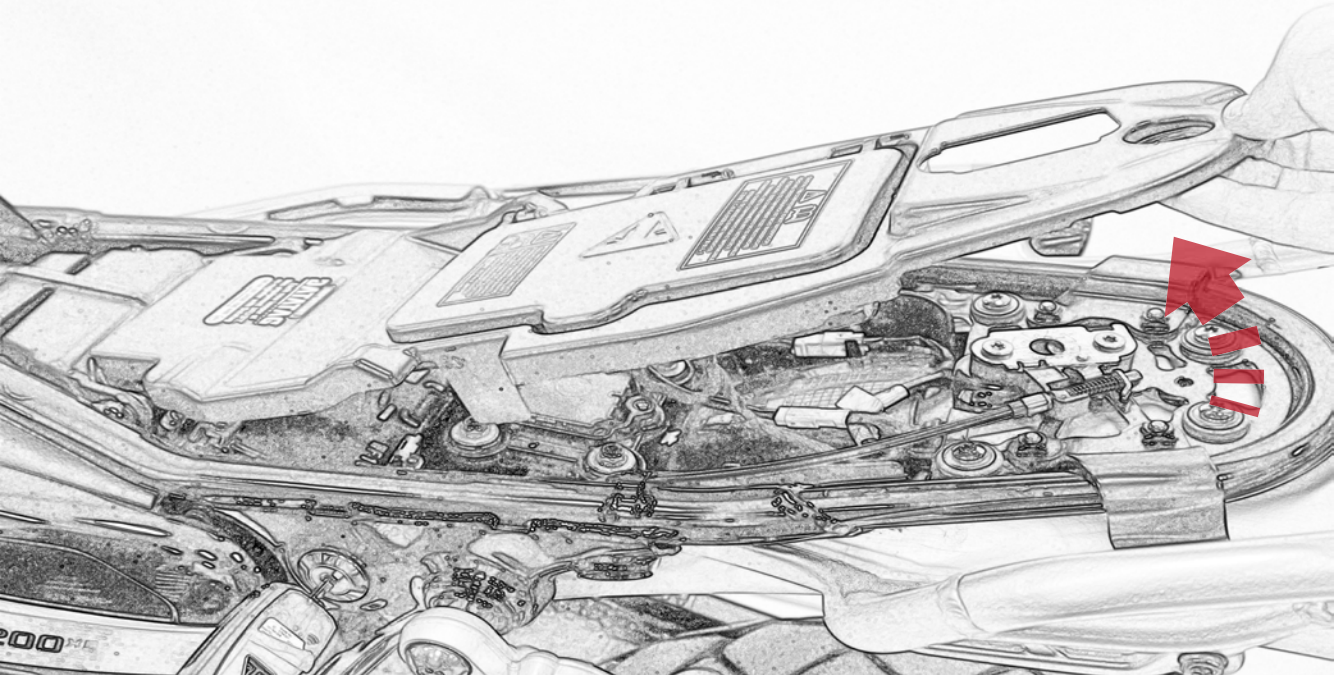

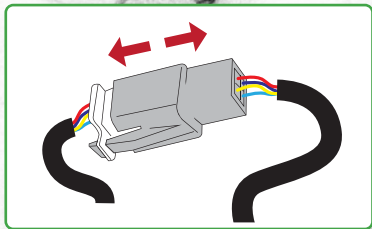
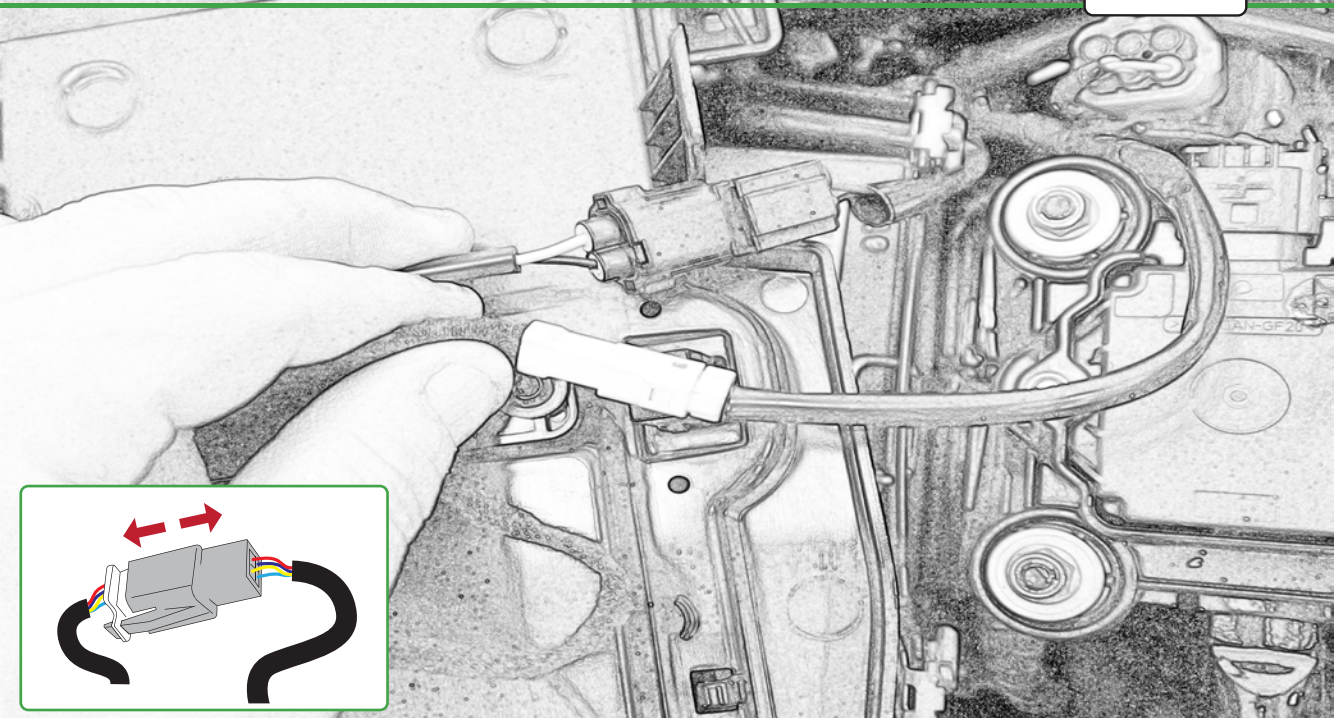



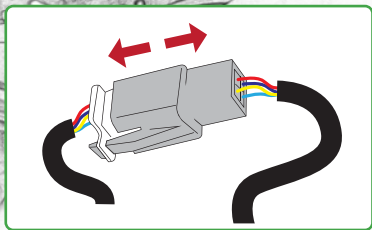

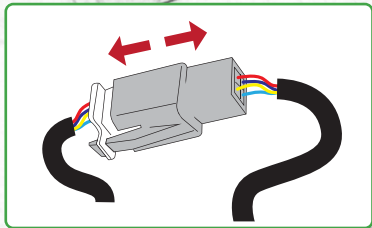

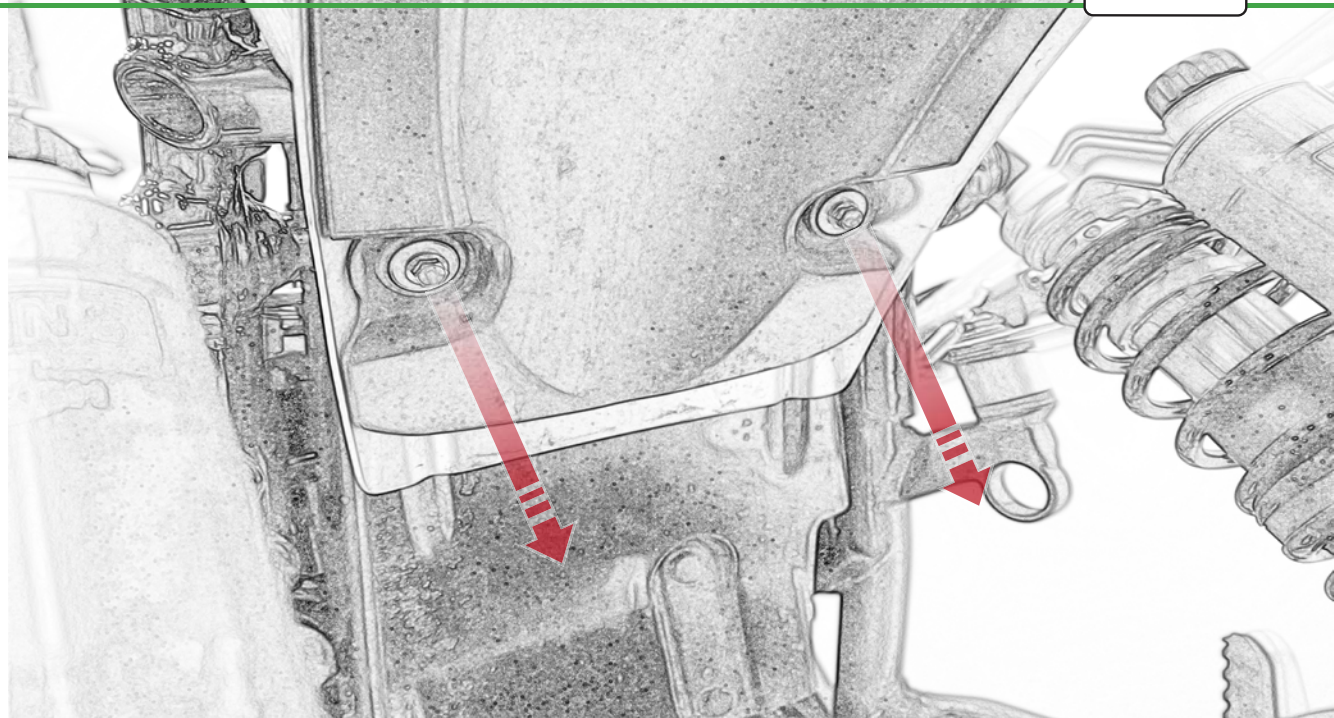

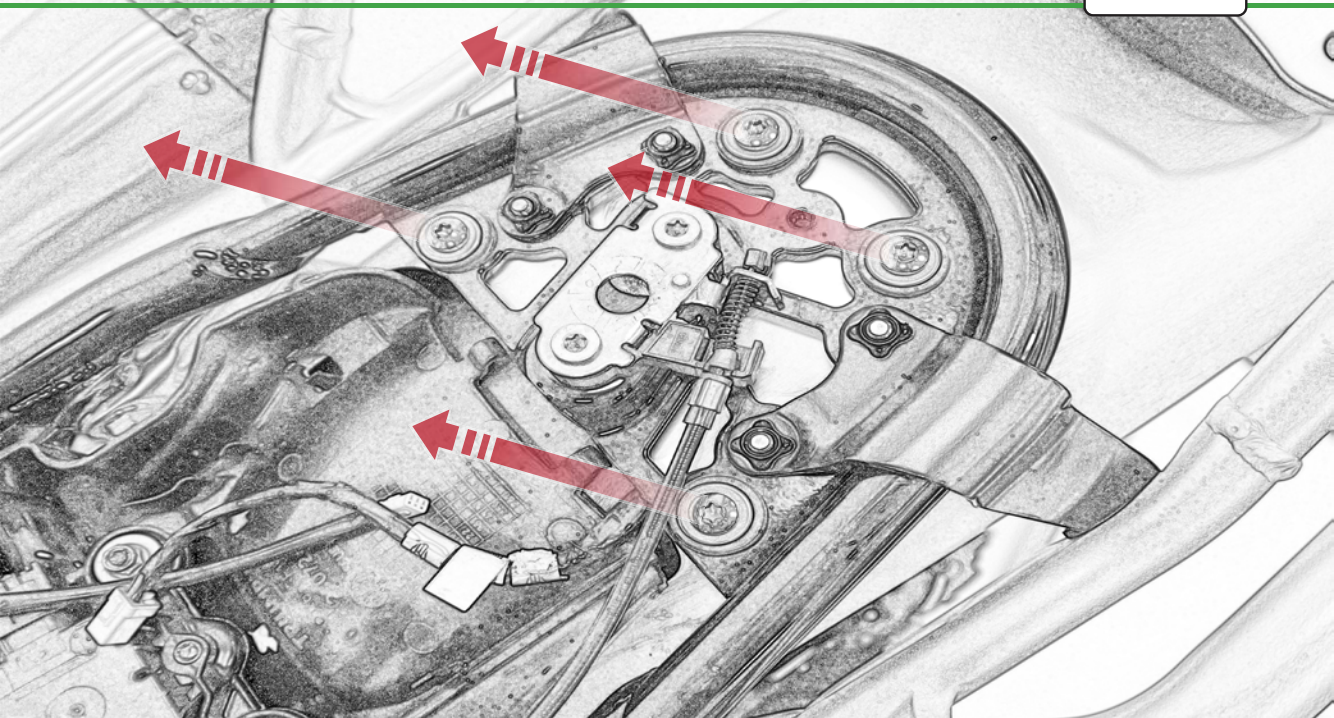

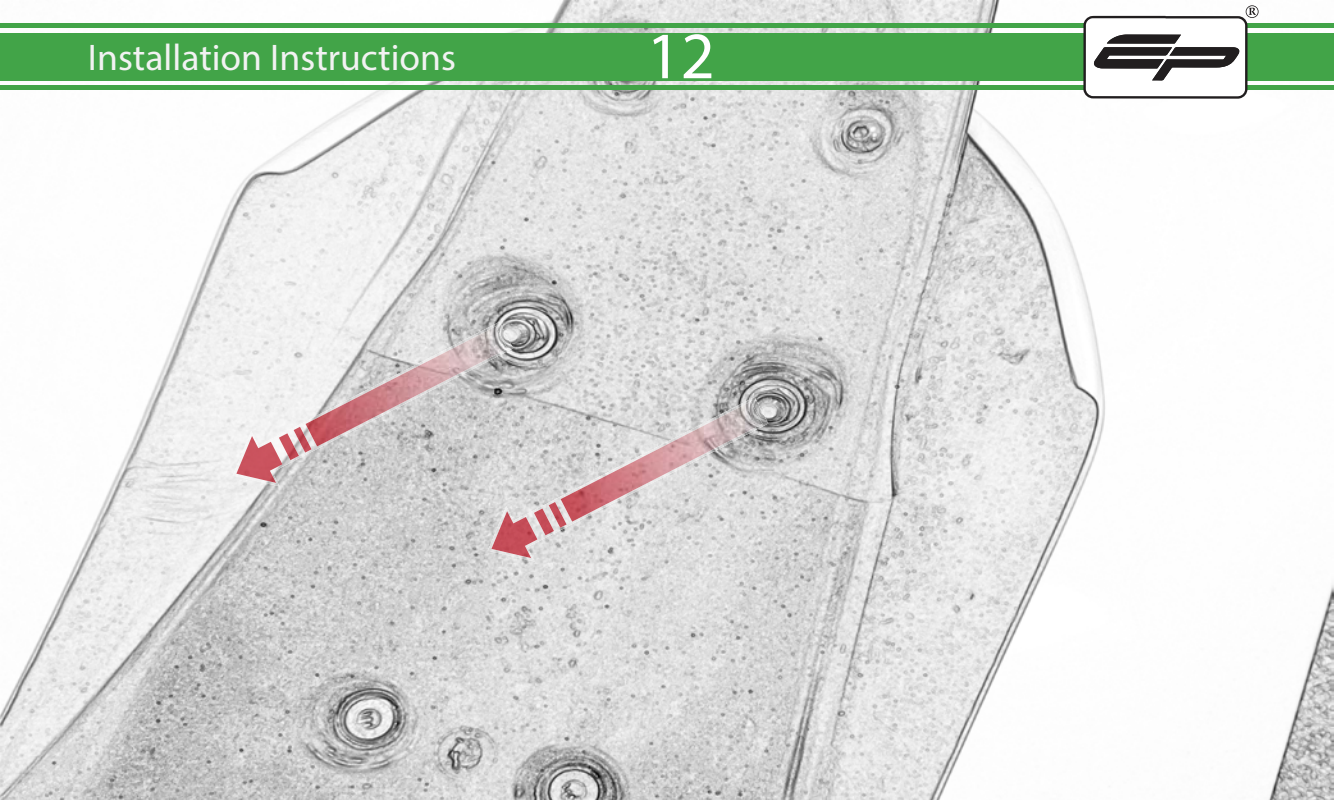

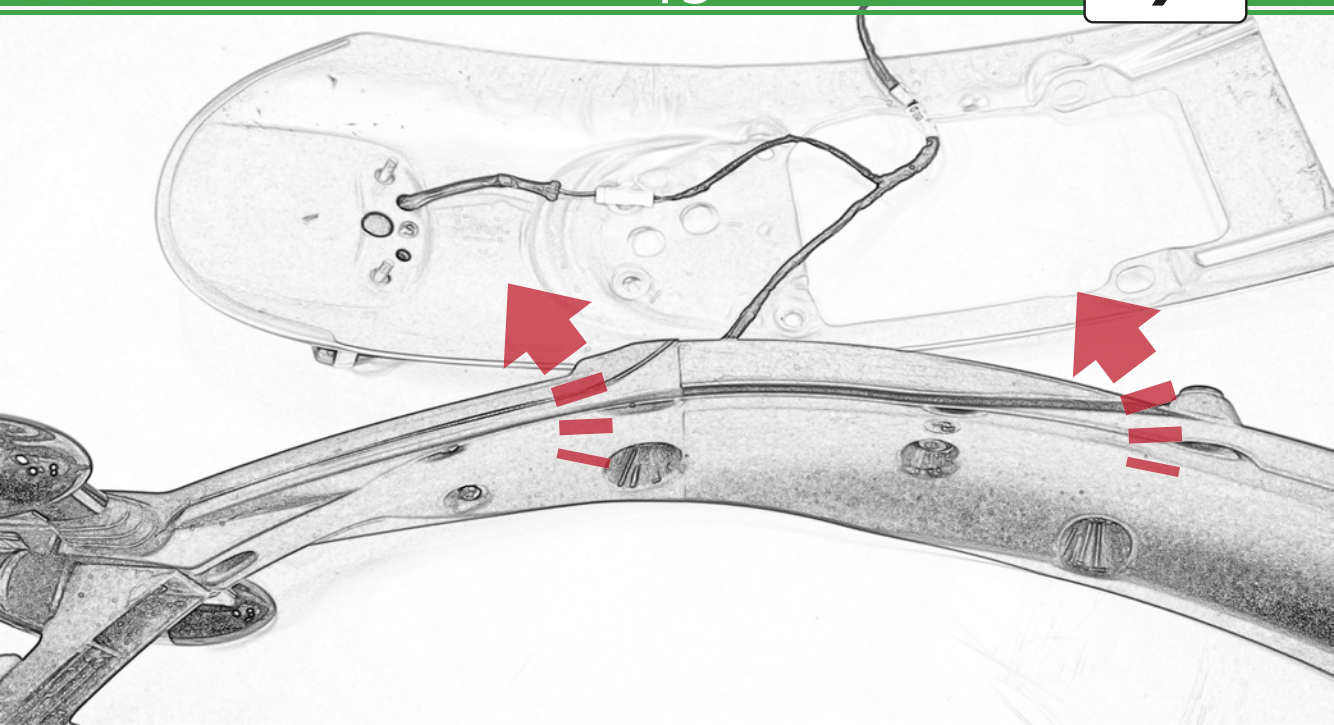

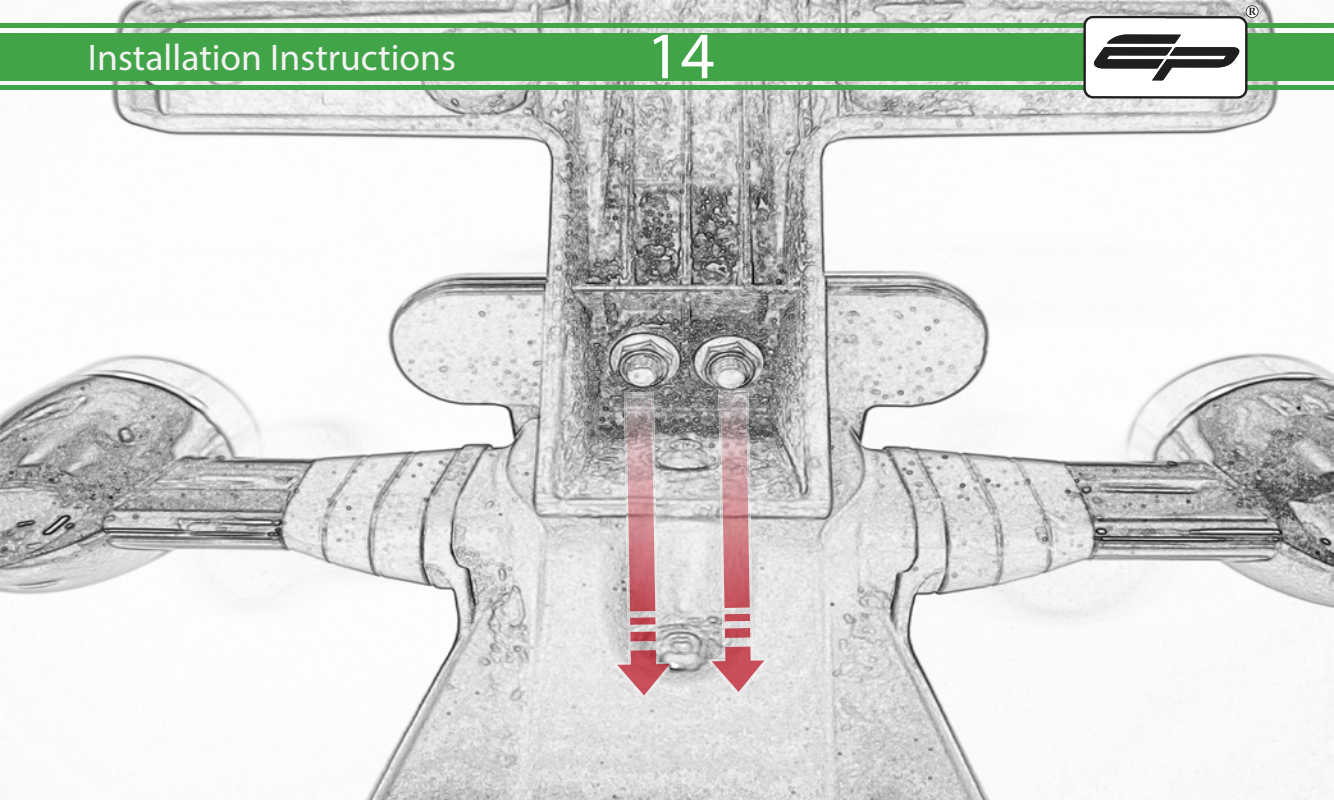

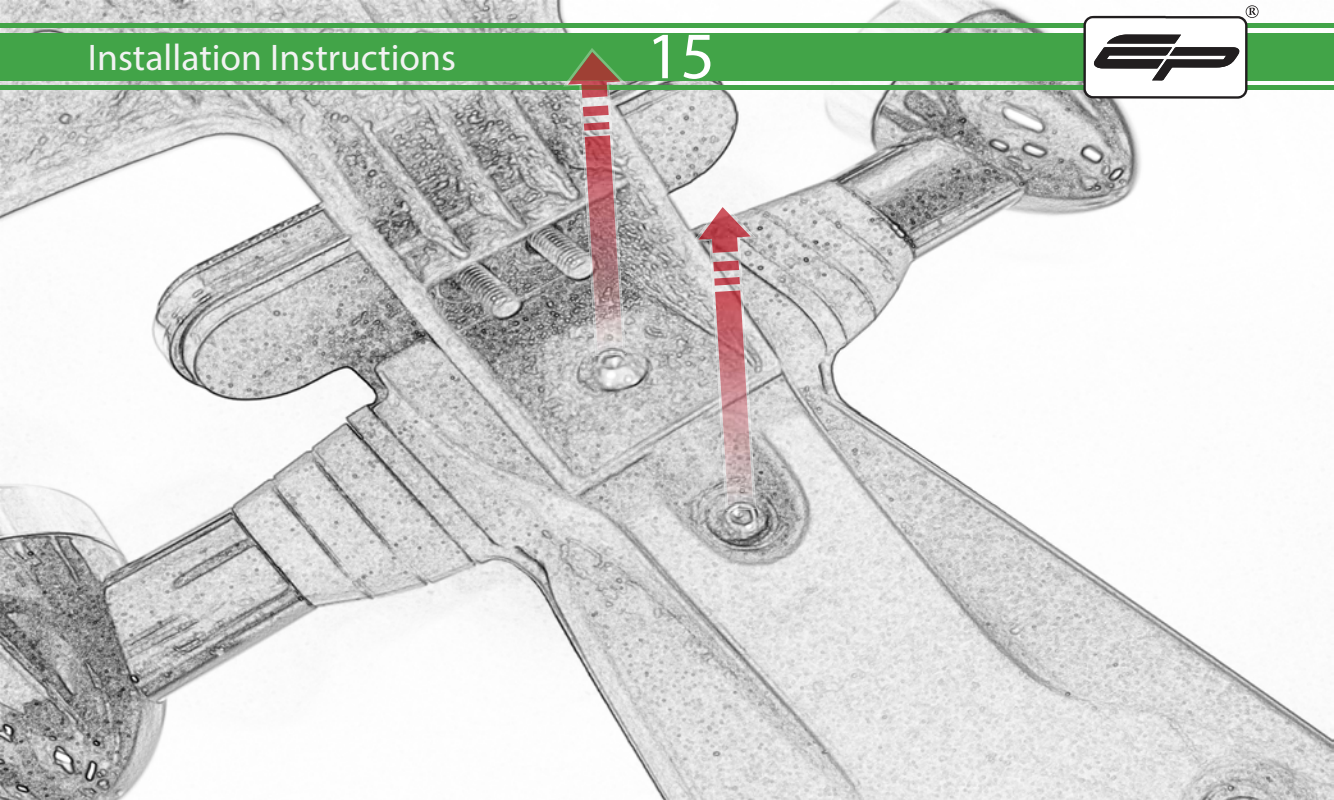

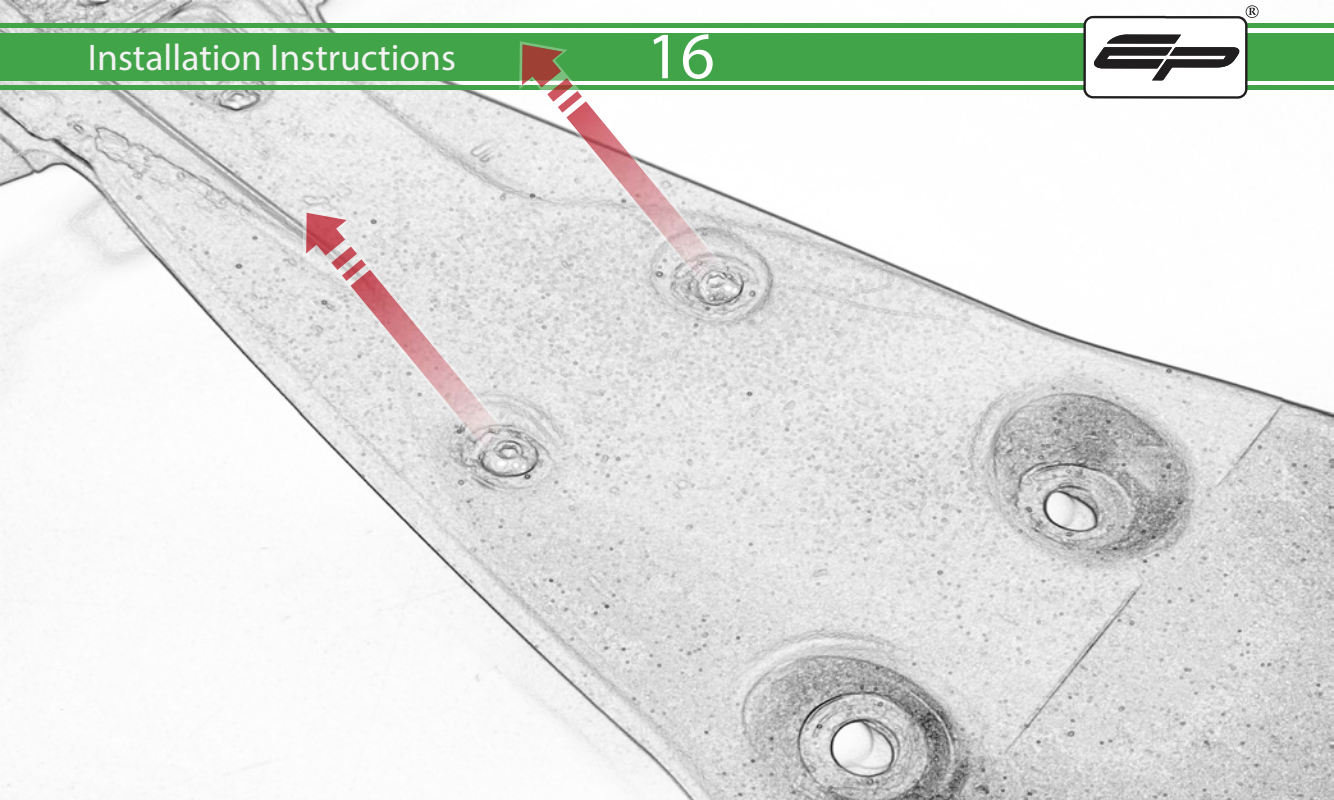

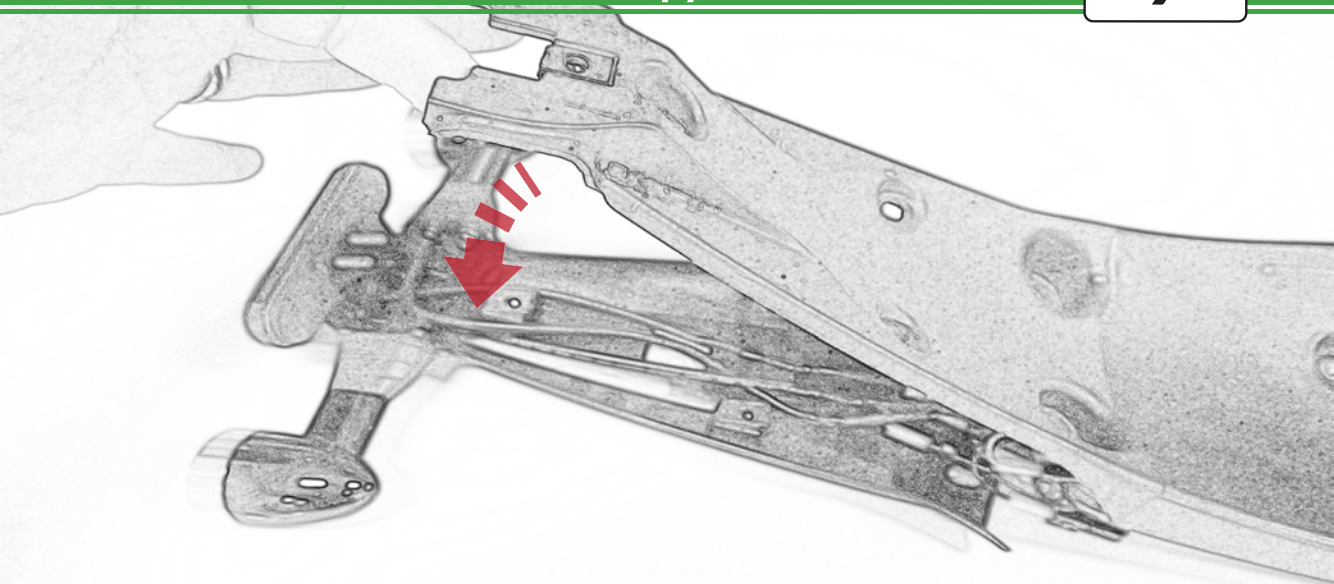

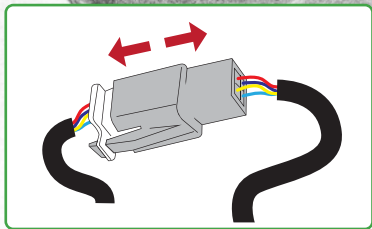
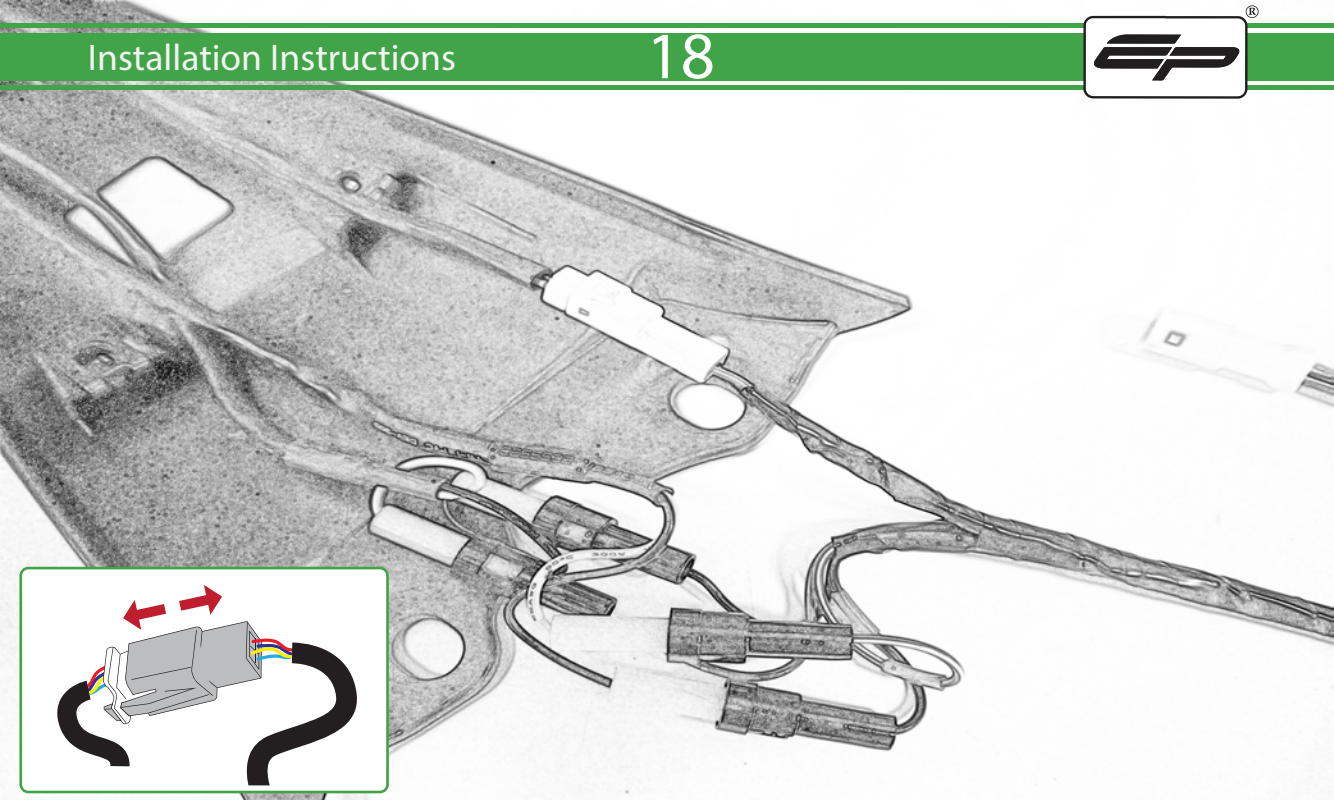

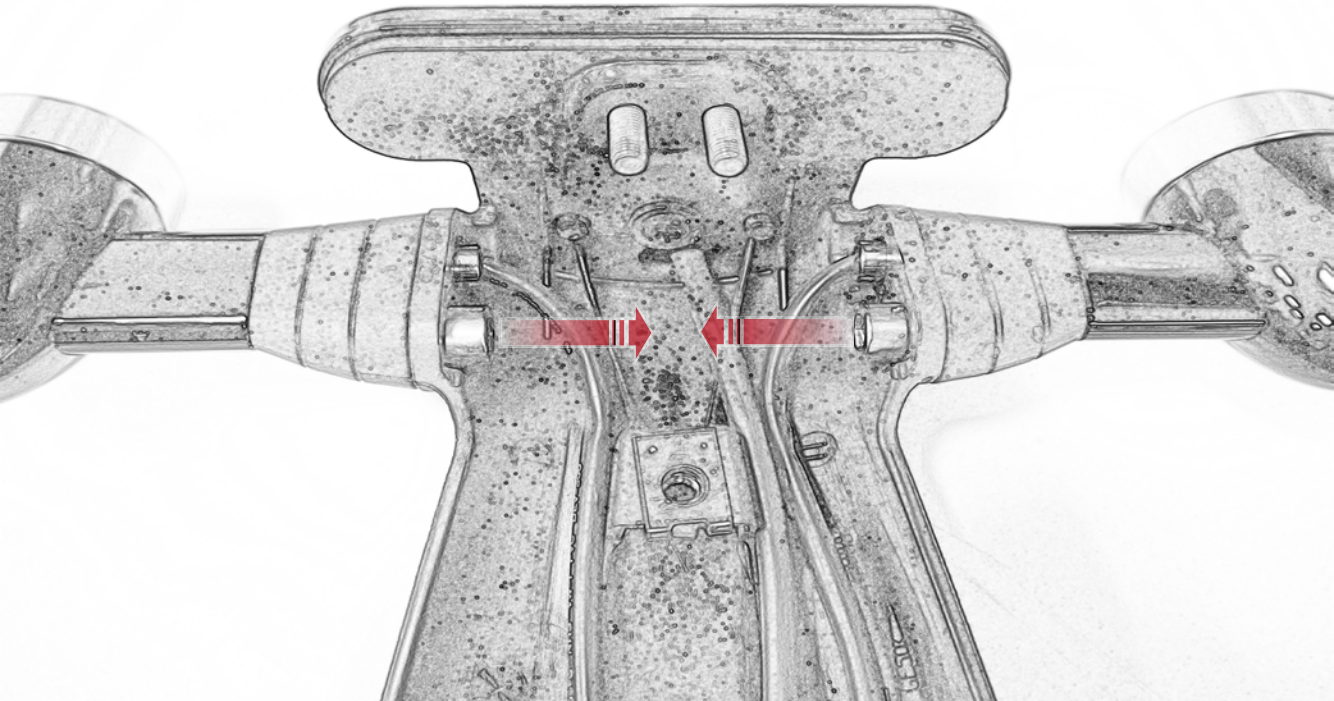

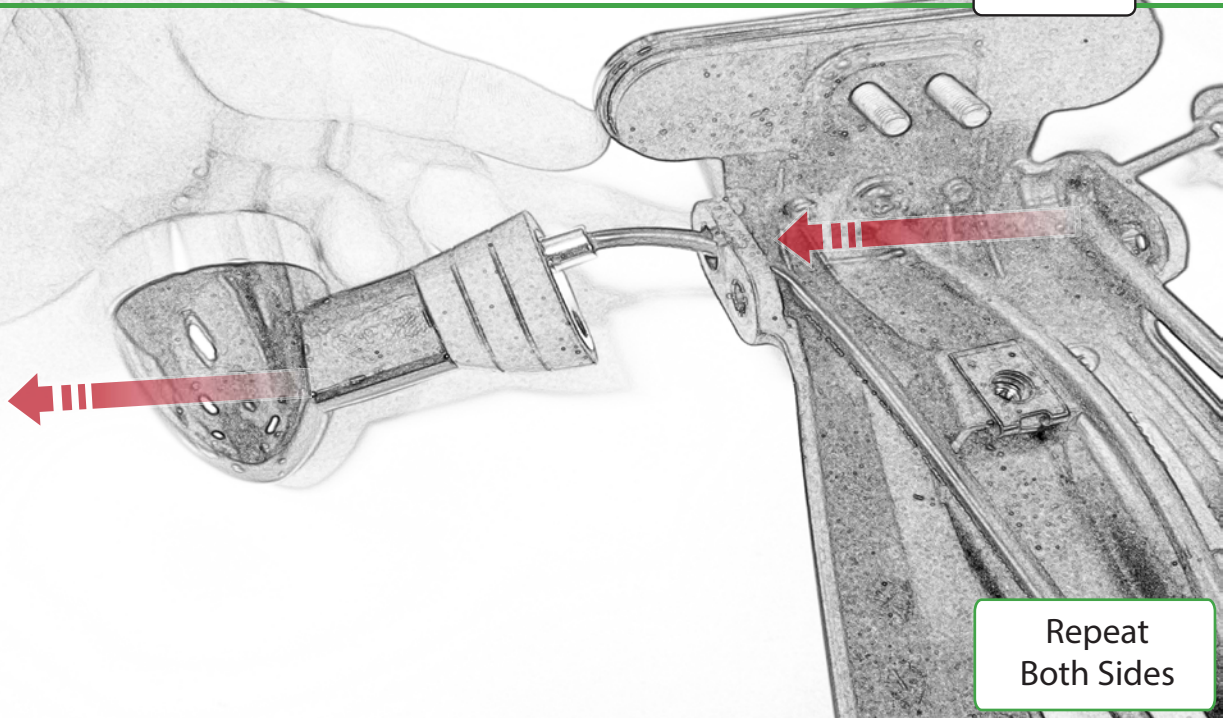

Repeat
Both Sides

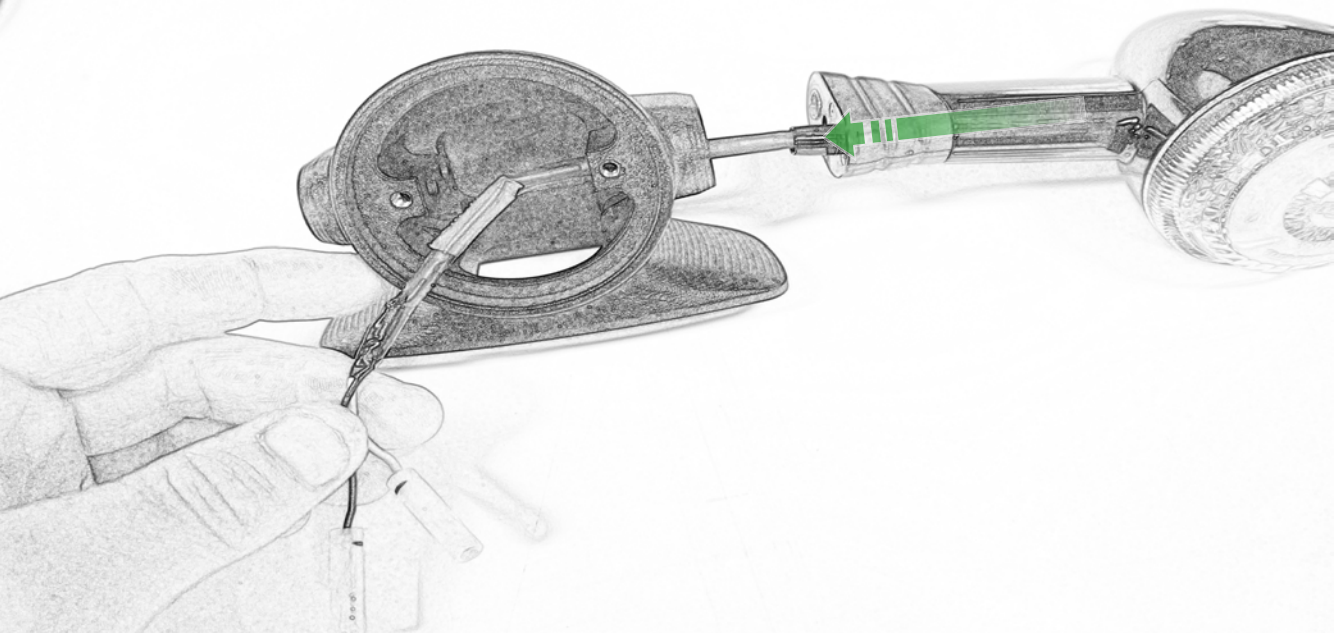

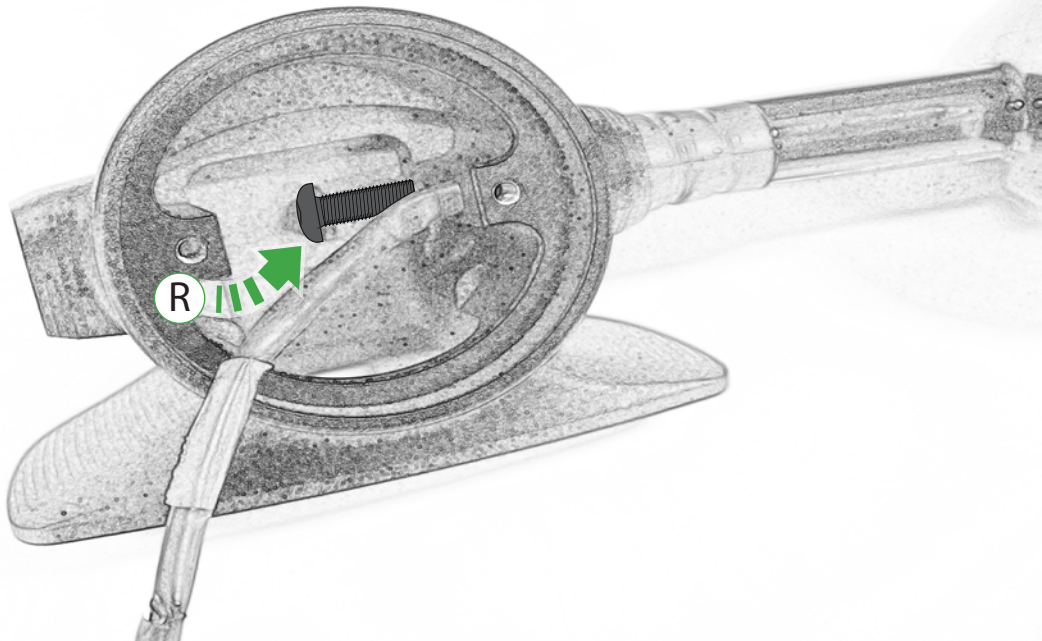

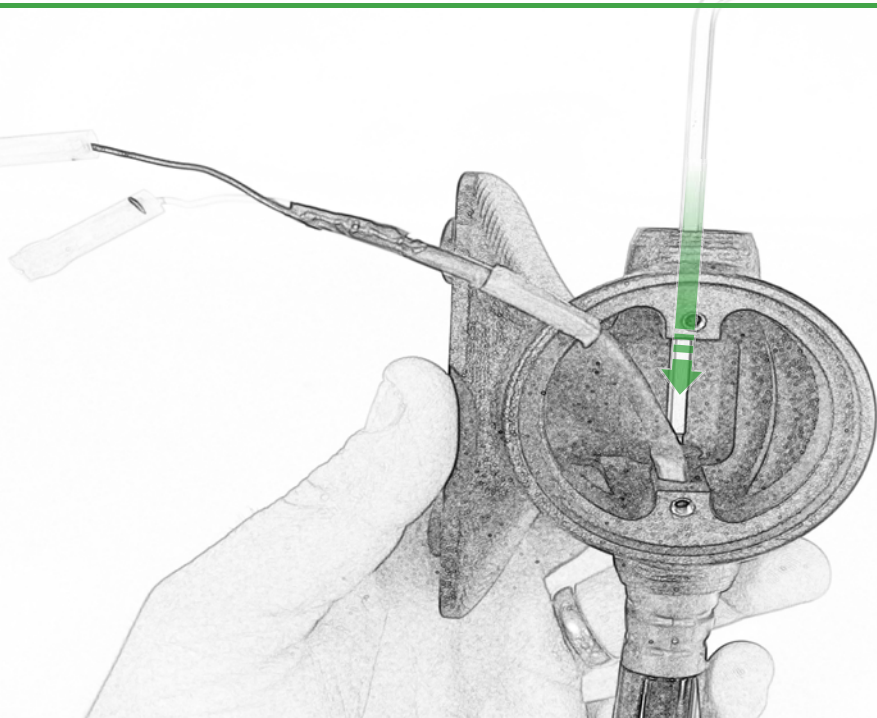

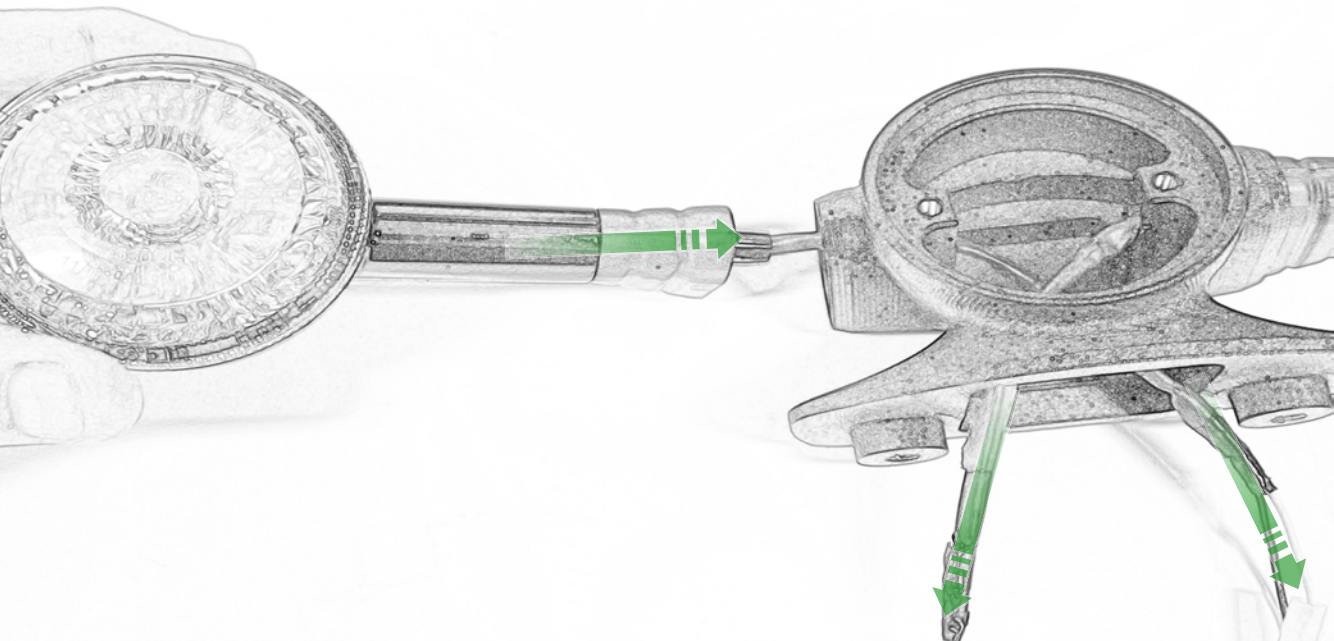

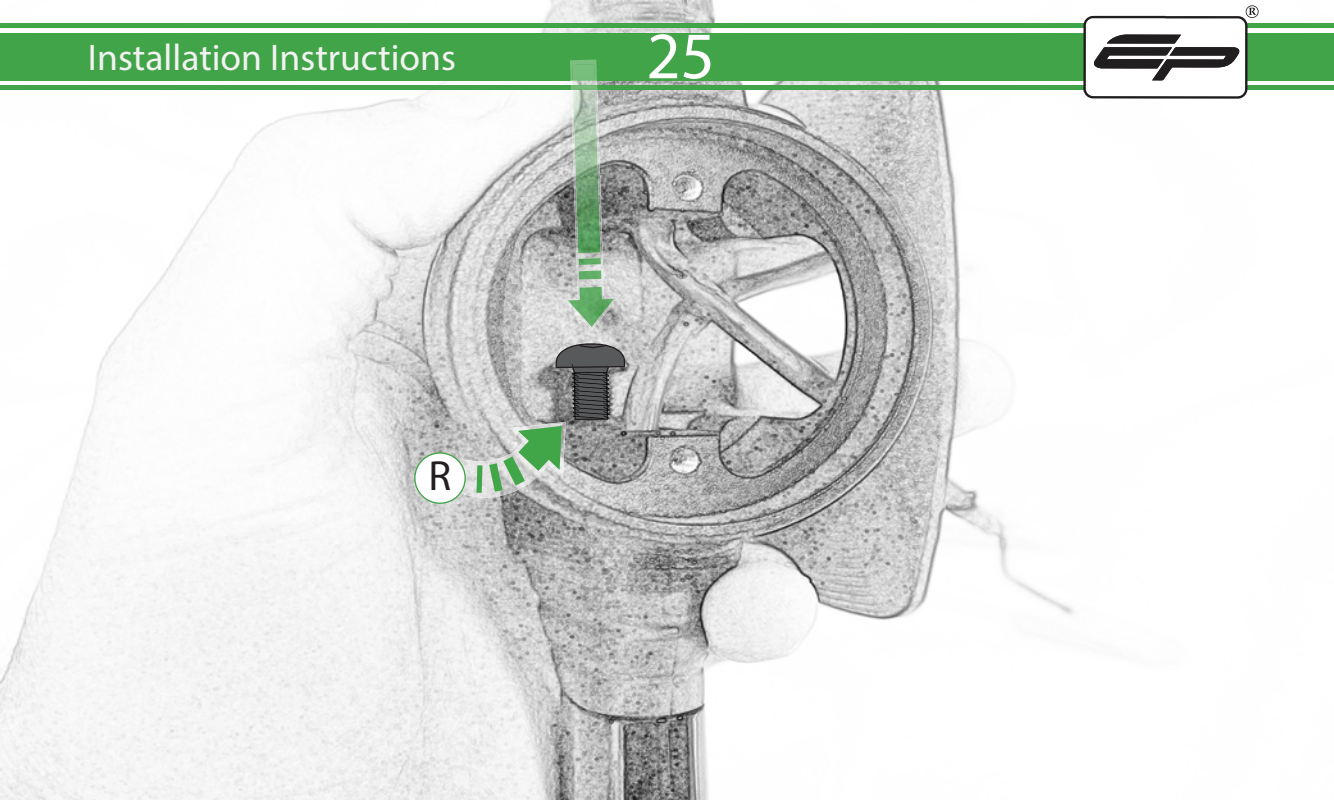

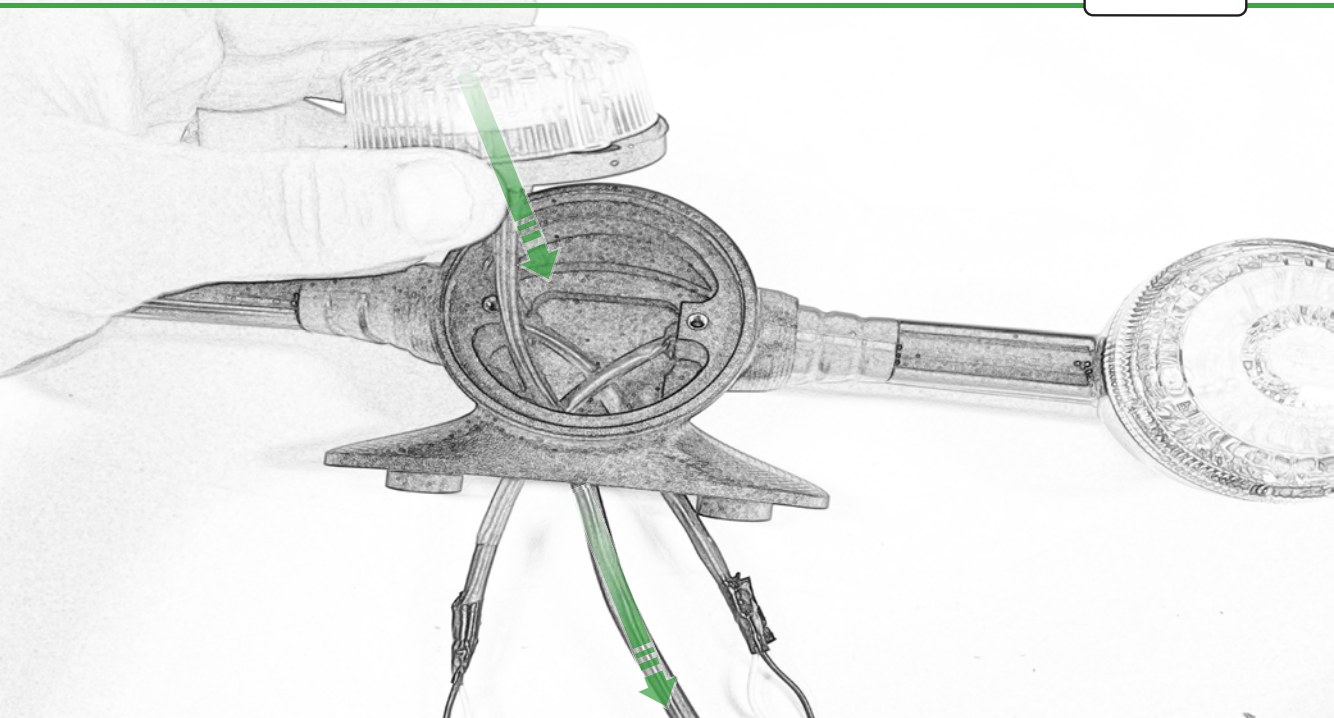

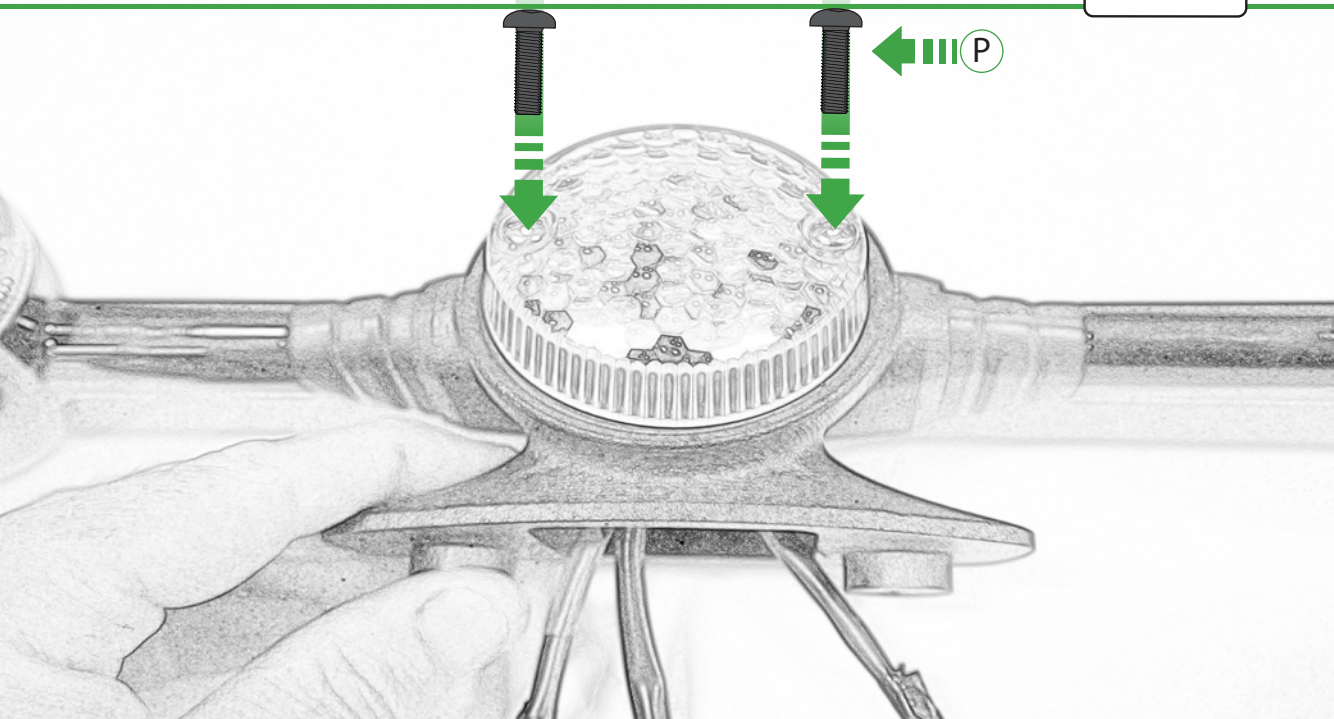

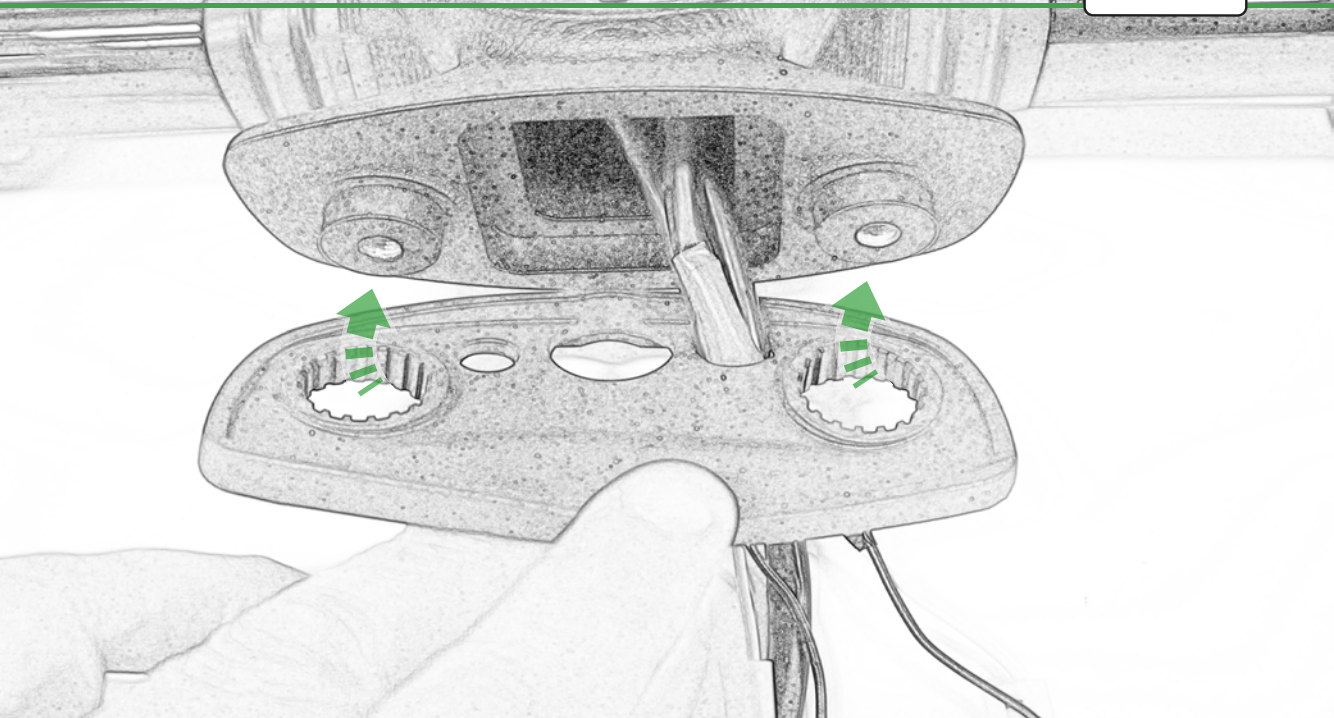

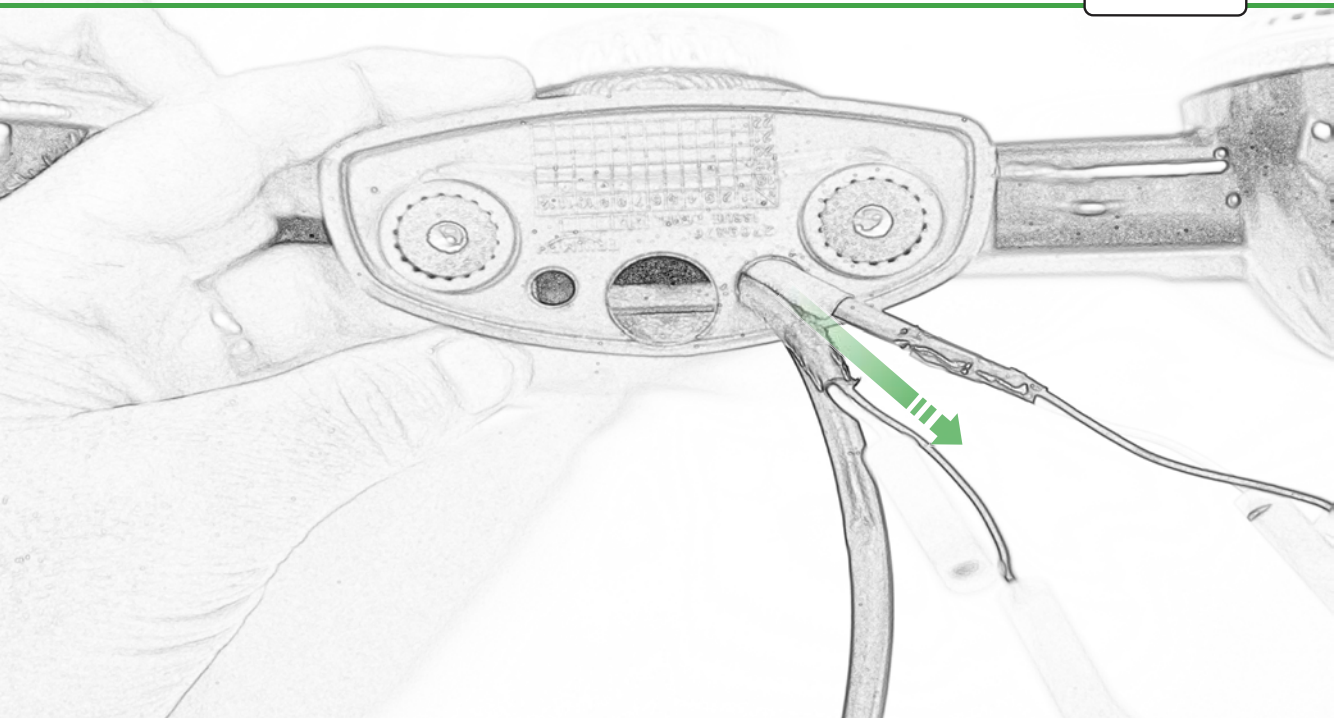

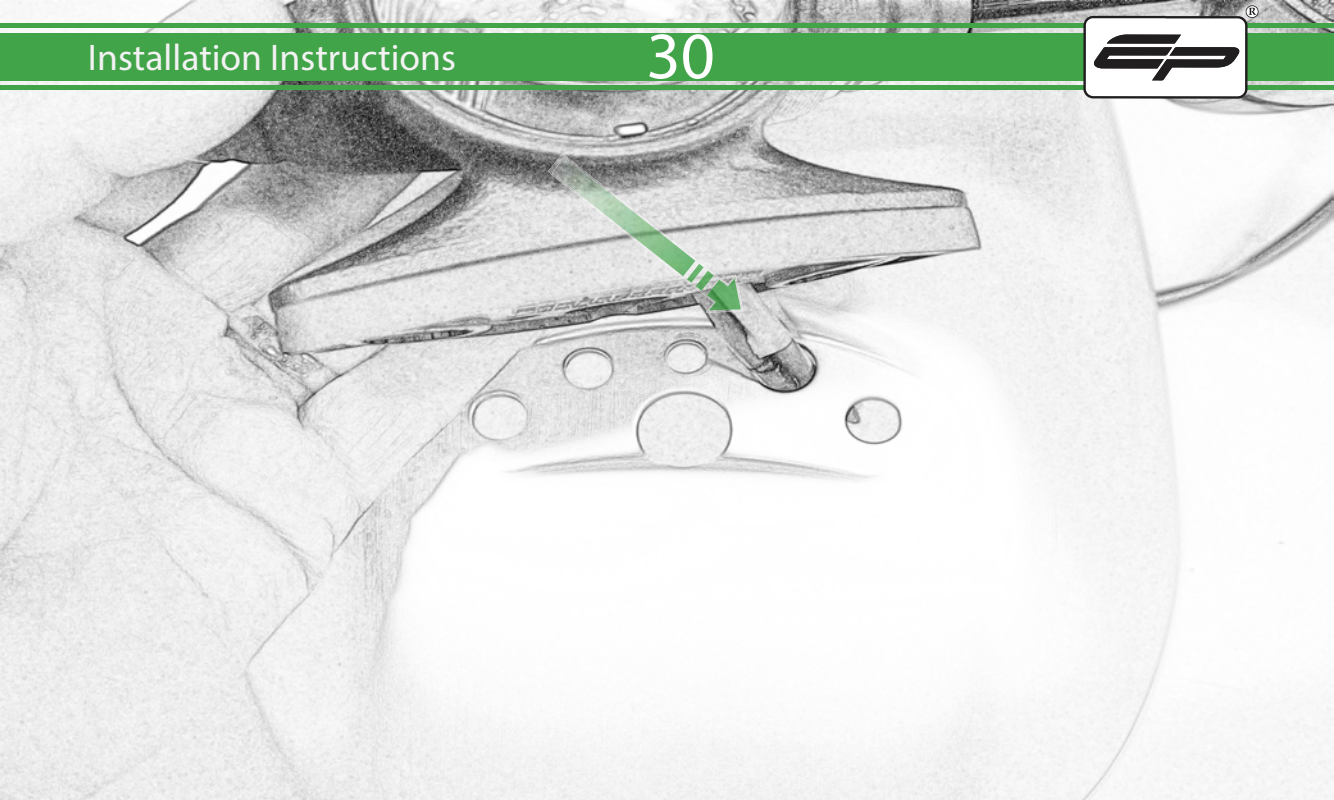

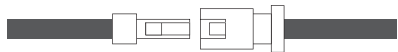
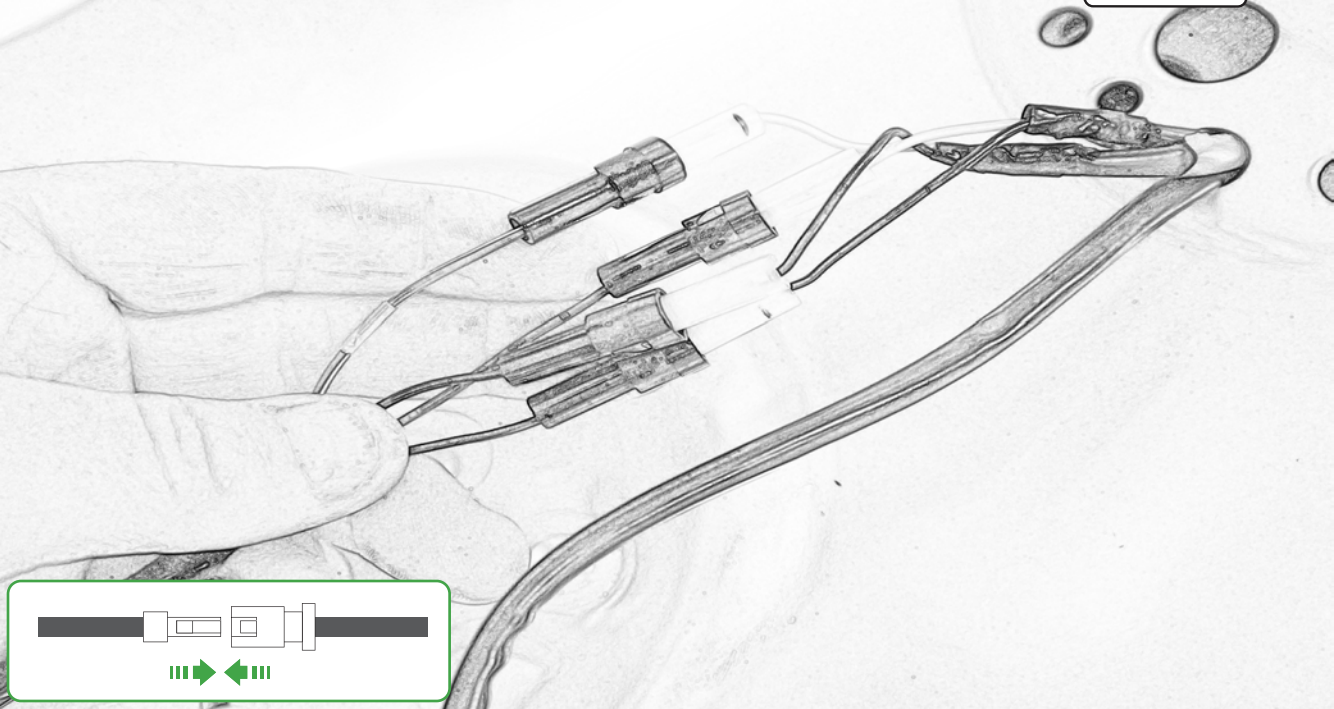

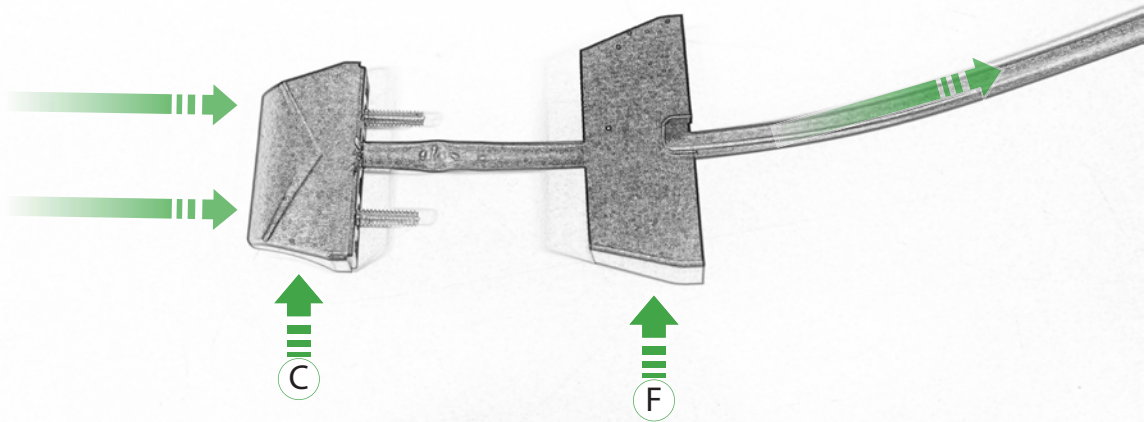

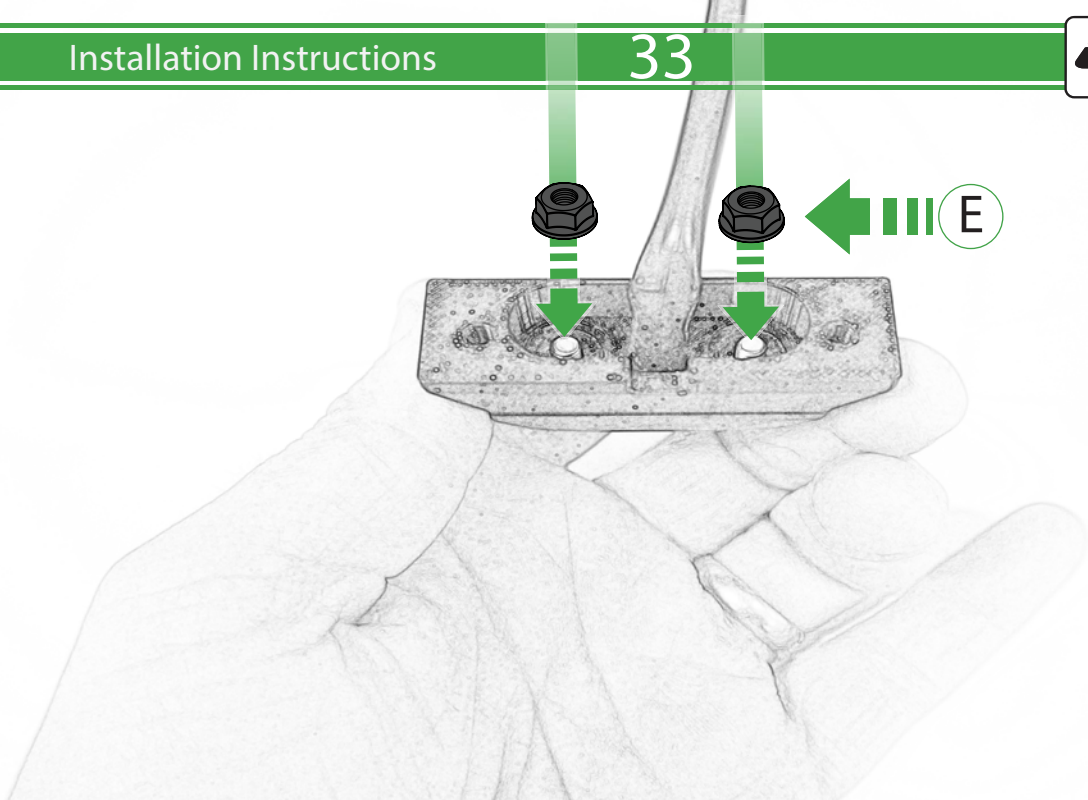

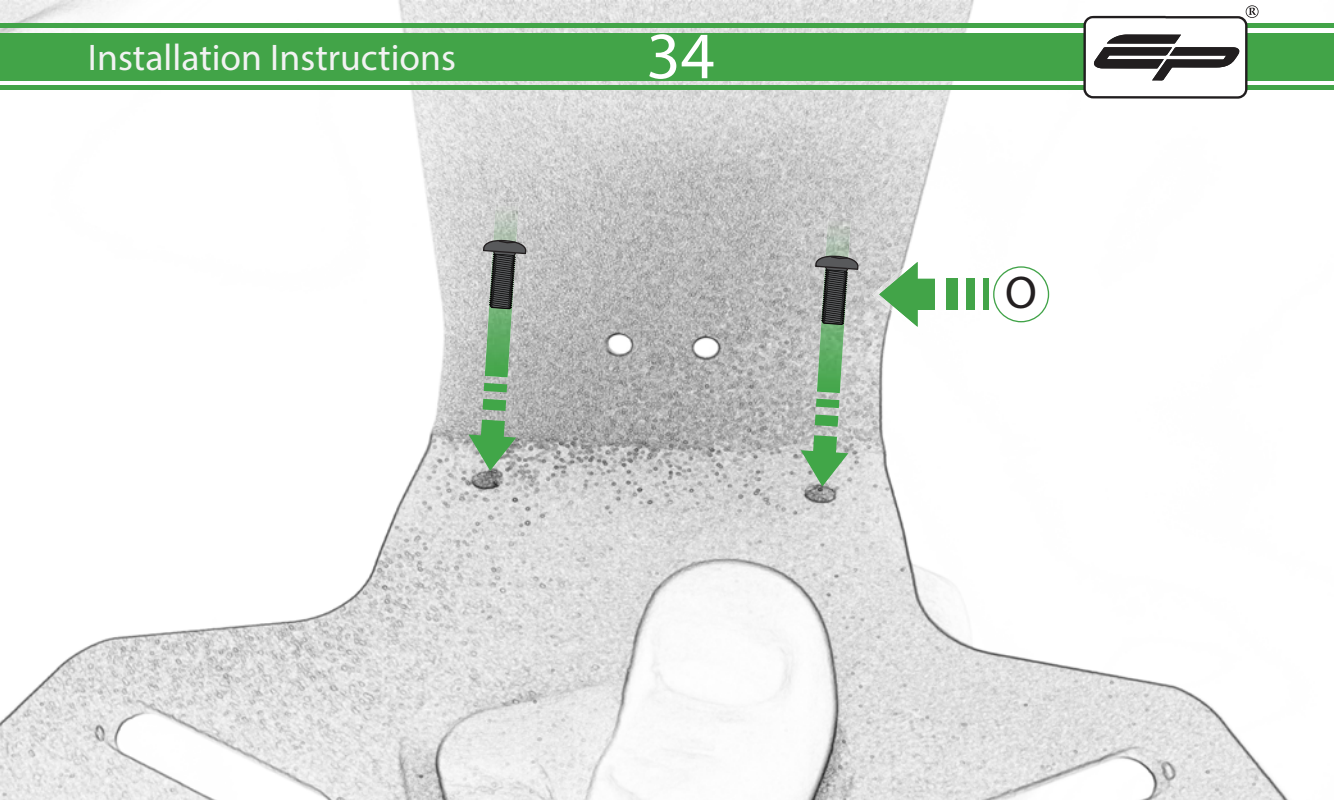

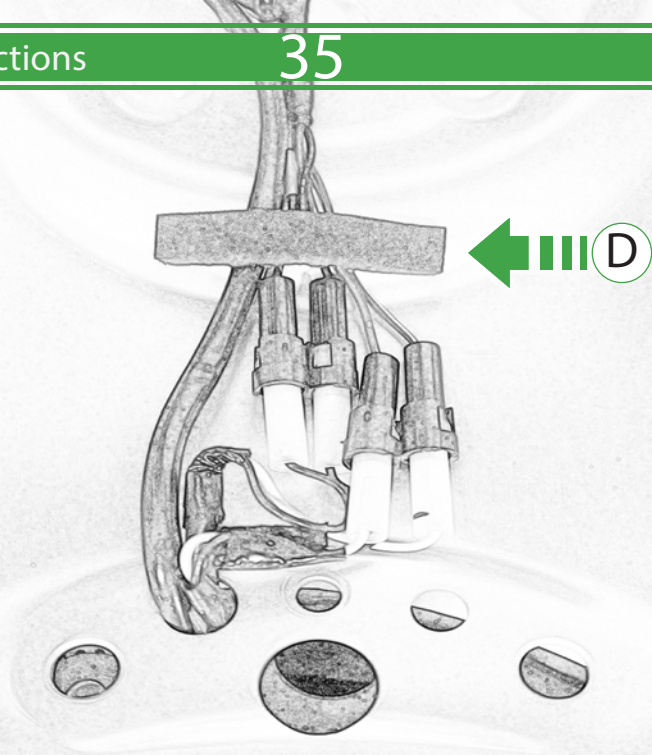

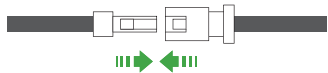
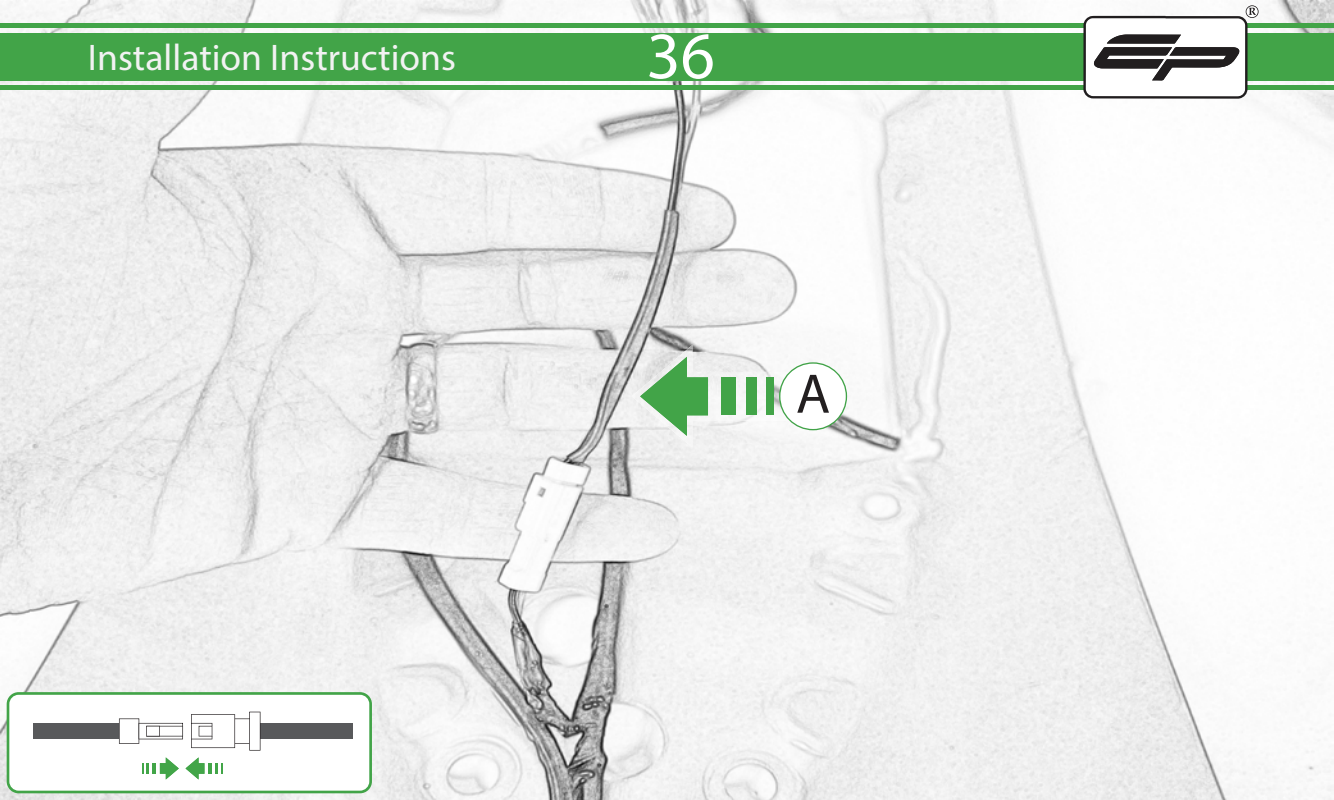

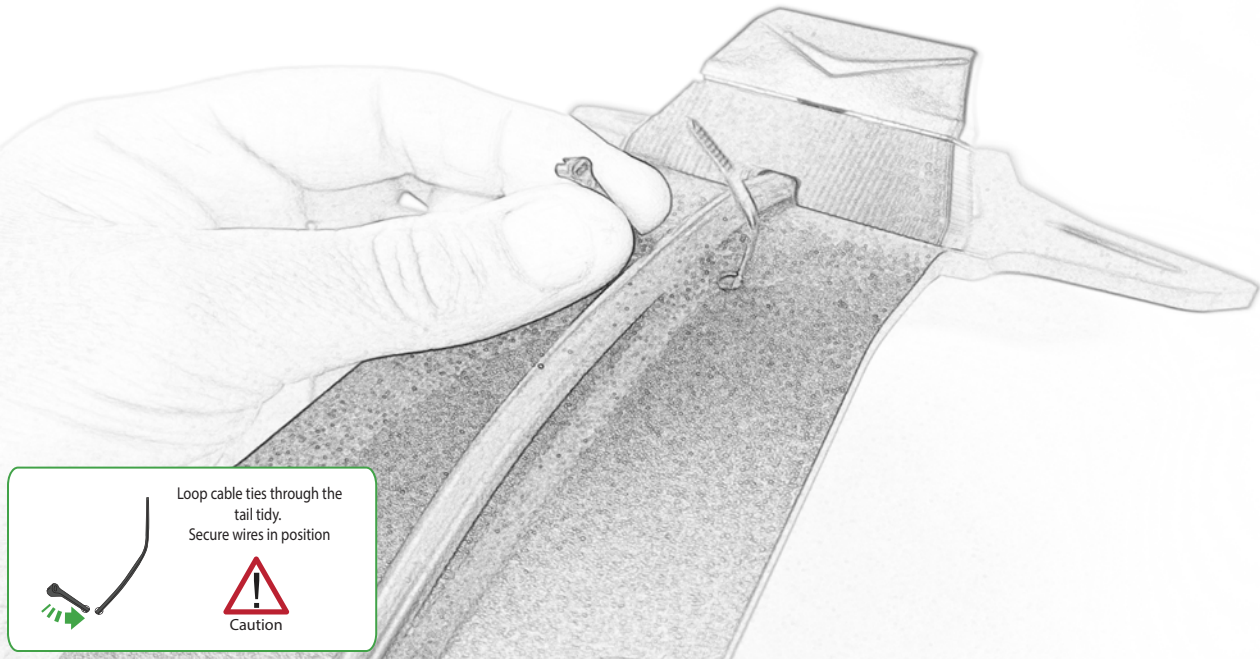

Loop cable ties through the
tail tidy.
Secure wires in position



Caution

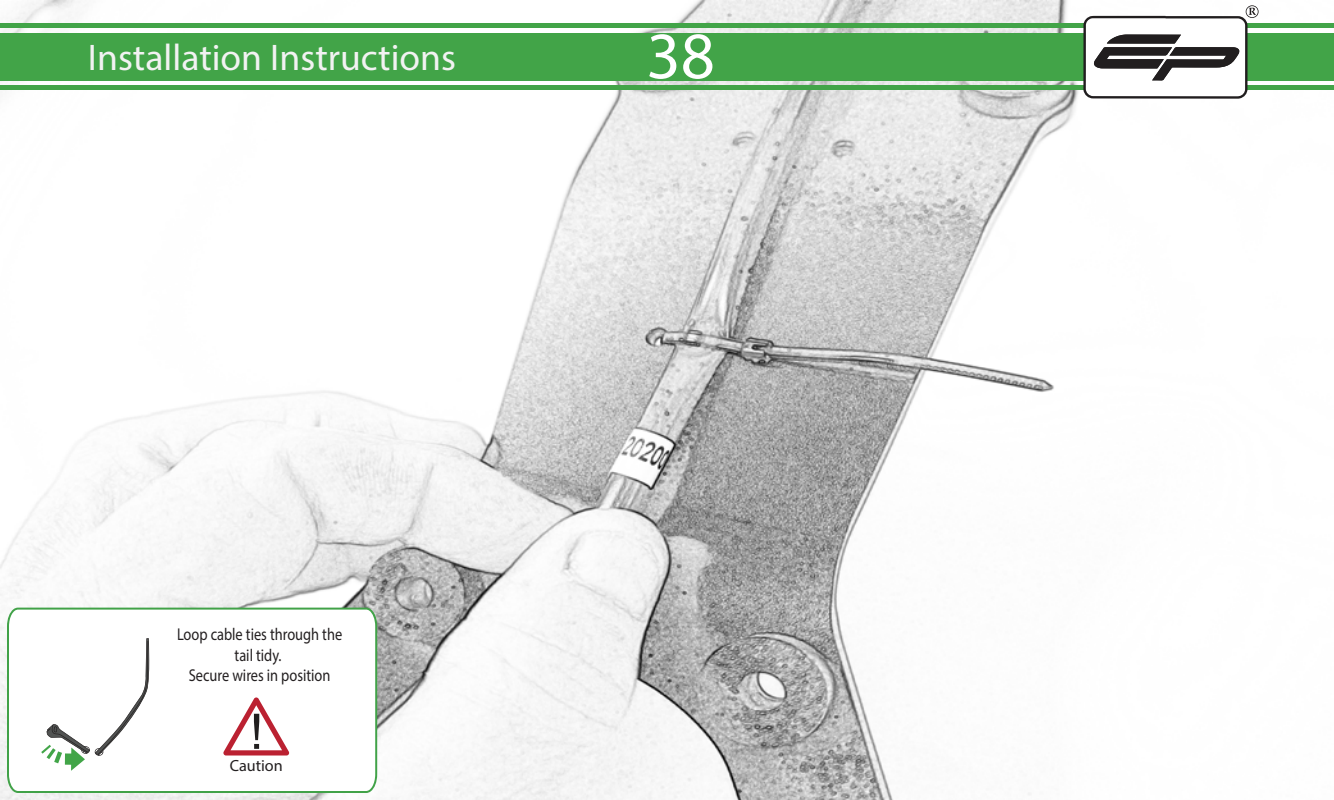

Loop cable ties through the
tail tidy.
Secure wires in position



Caution

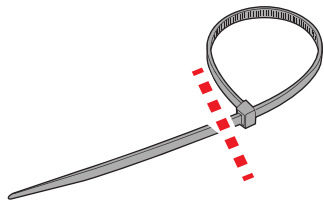
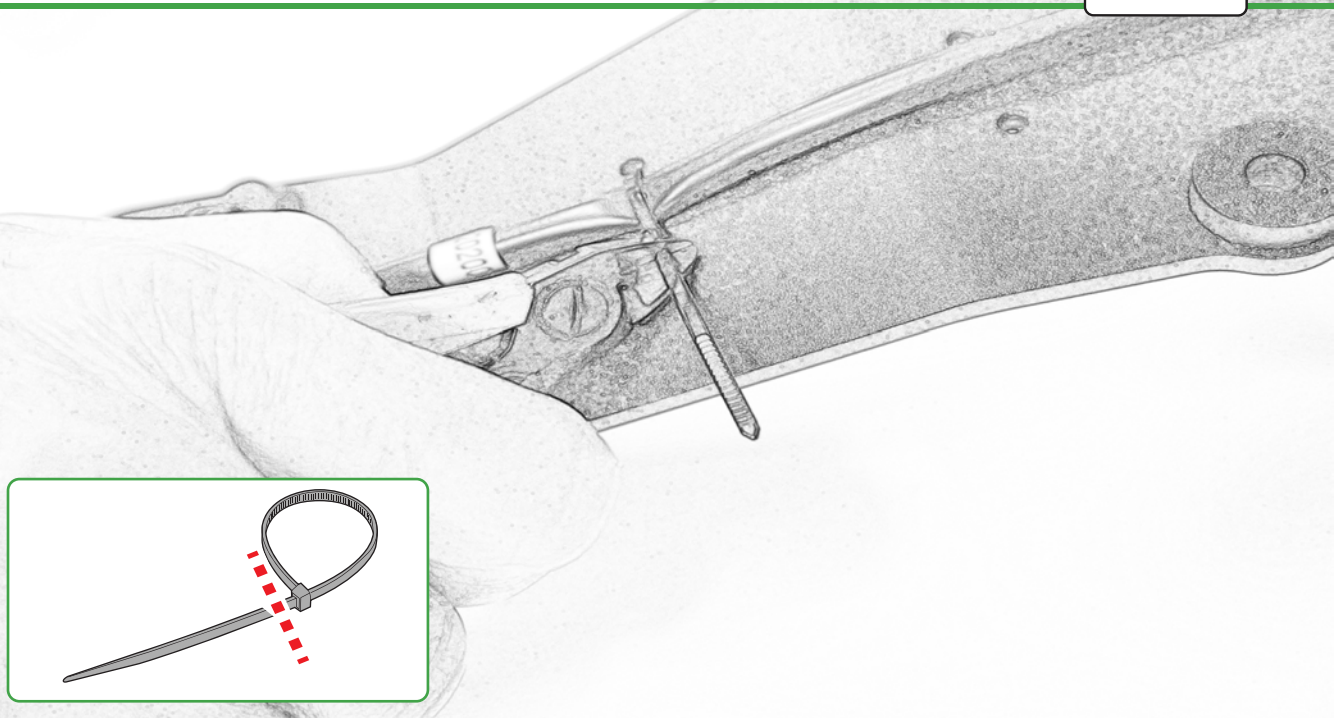

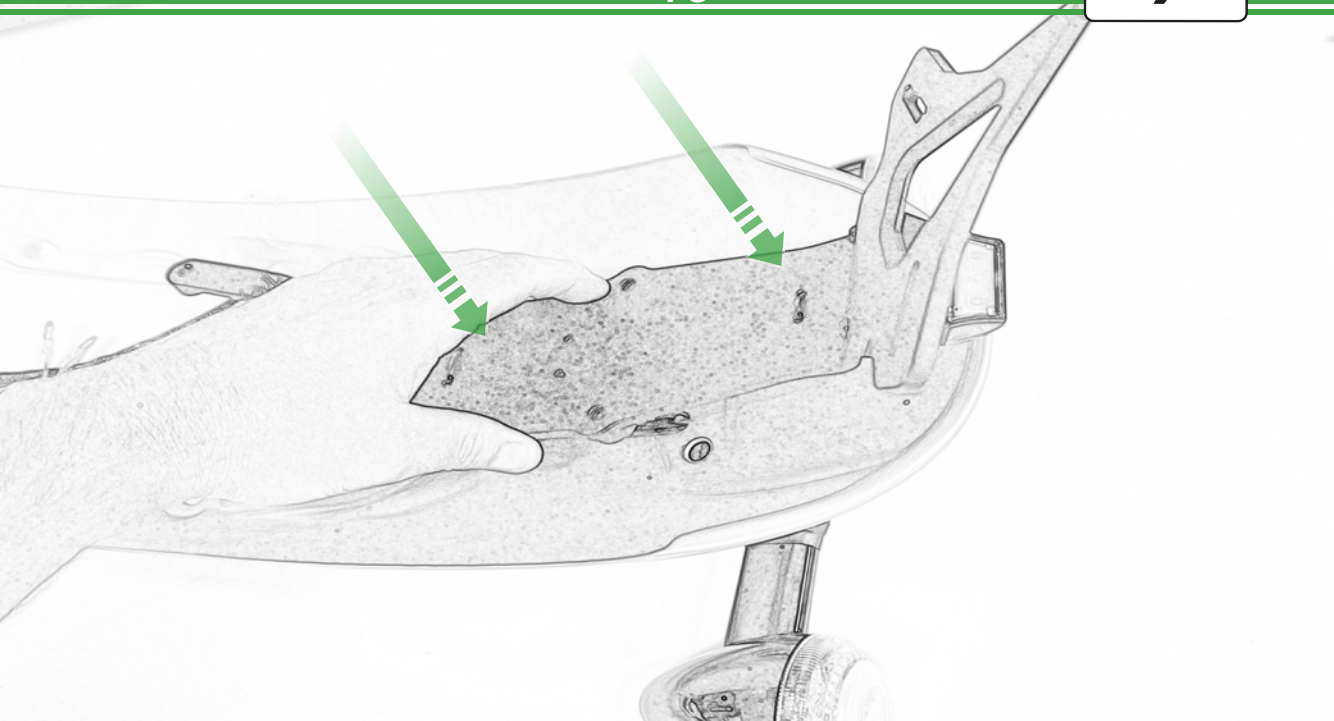



Run wires neatly down the channel
in both parts ensuring they
do not get trapped or squashed

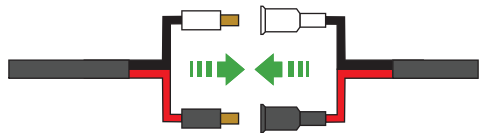
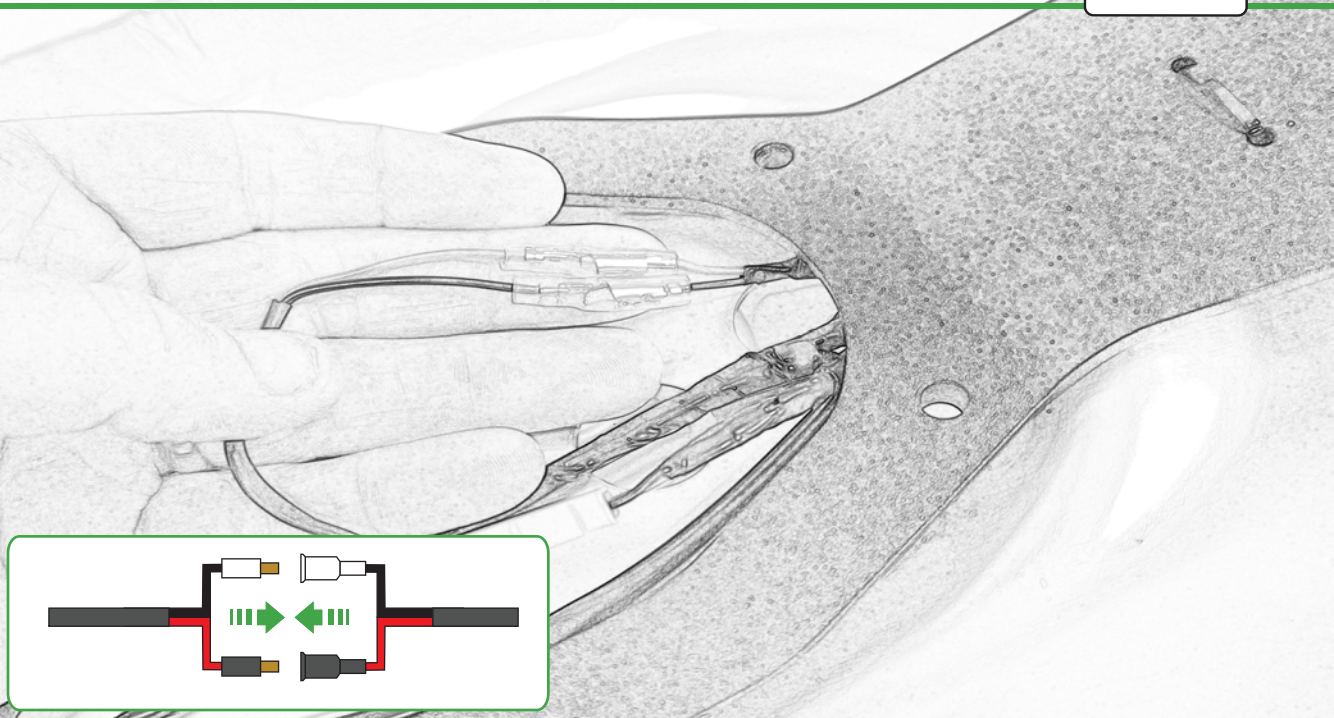

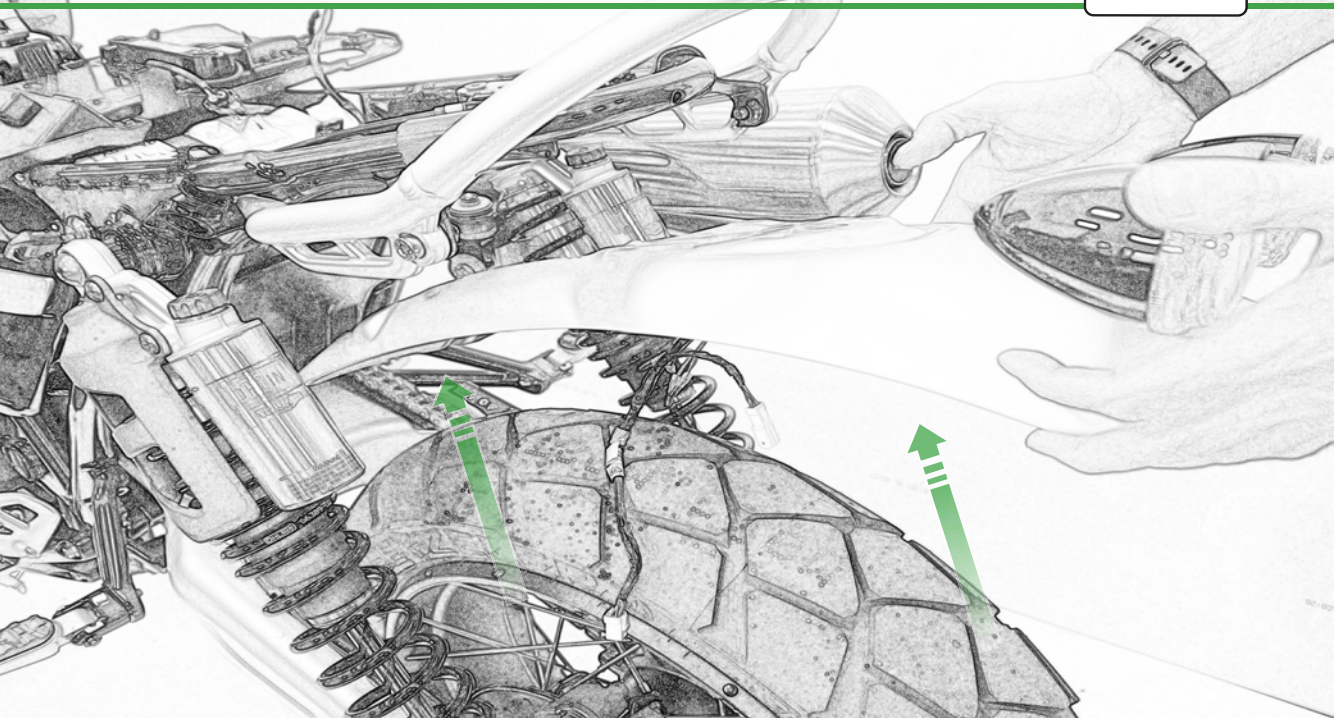

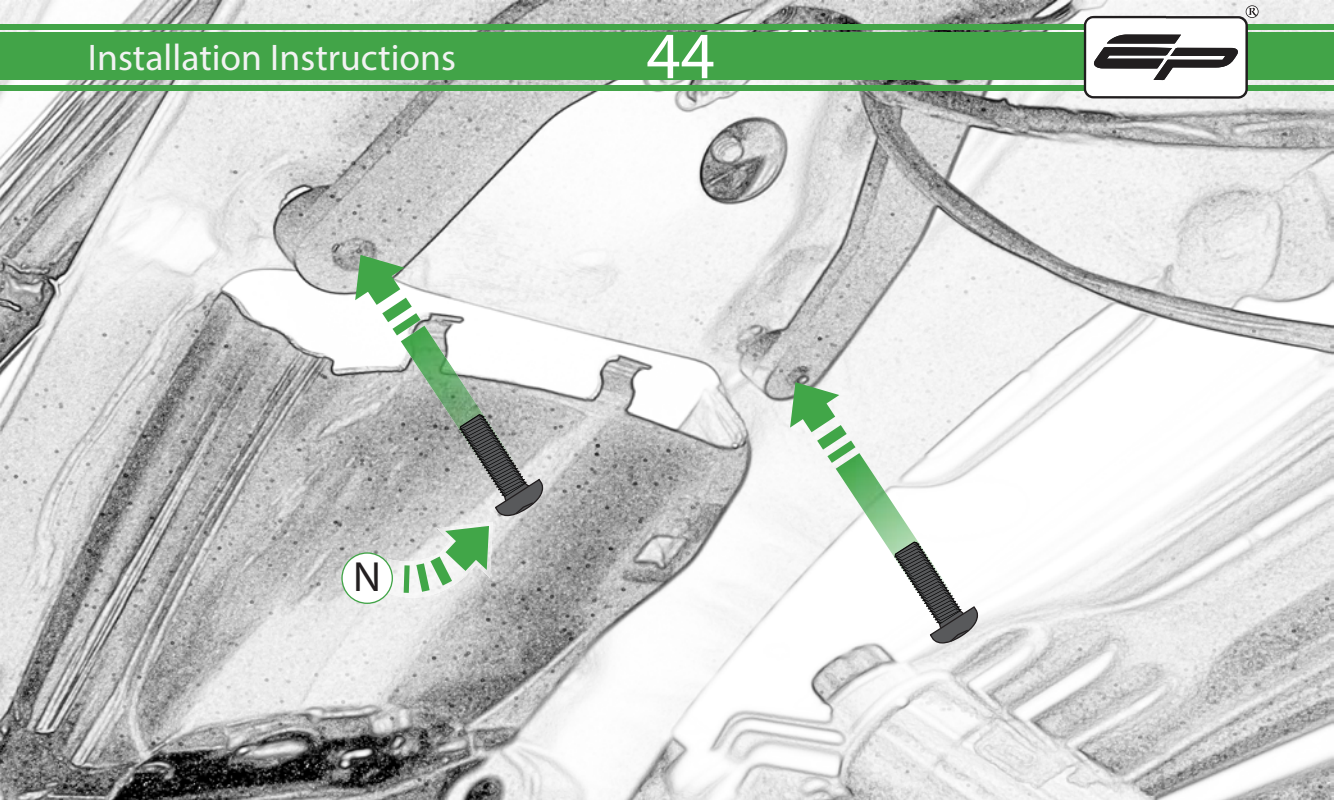

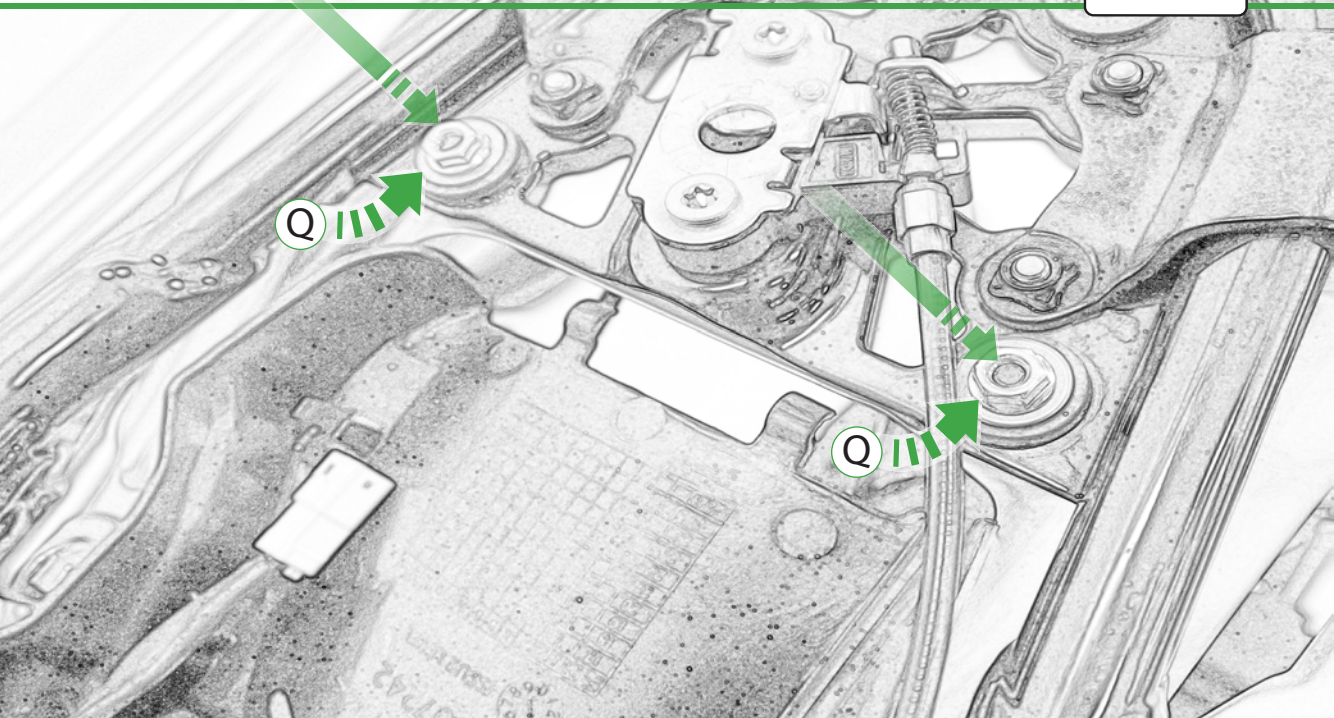



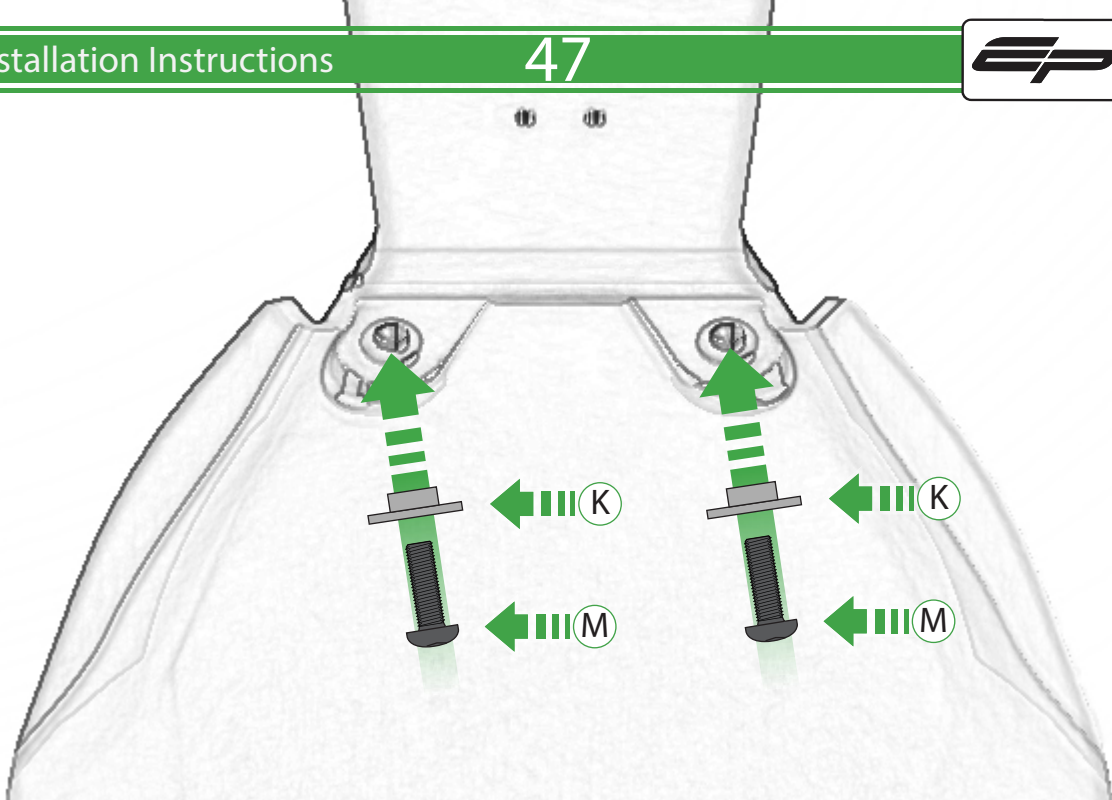

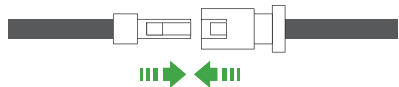
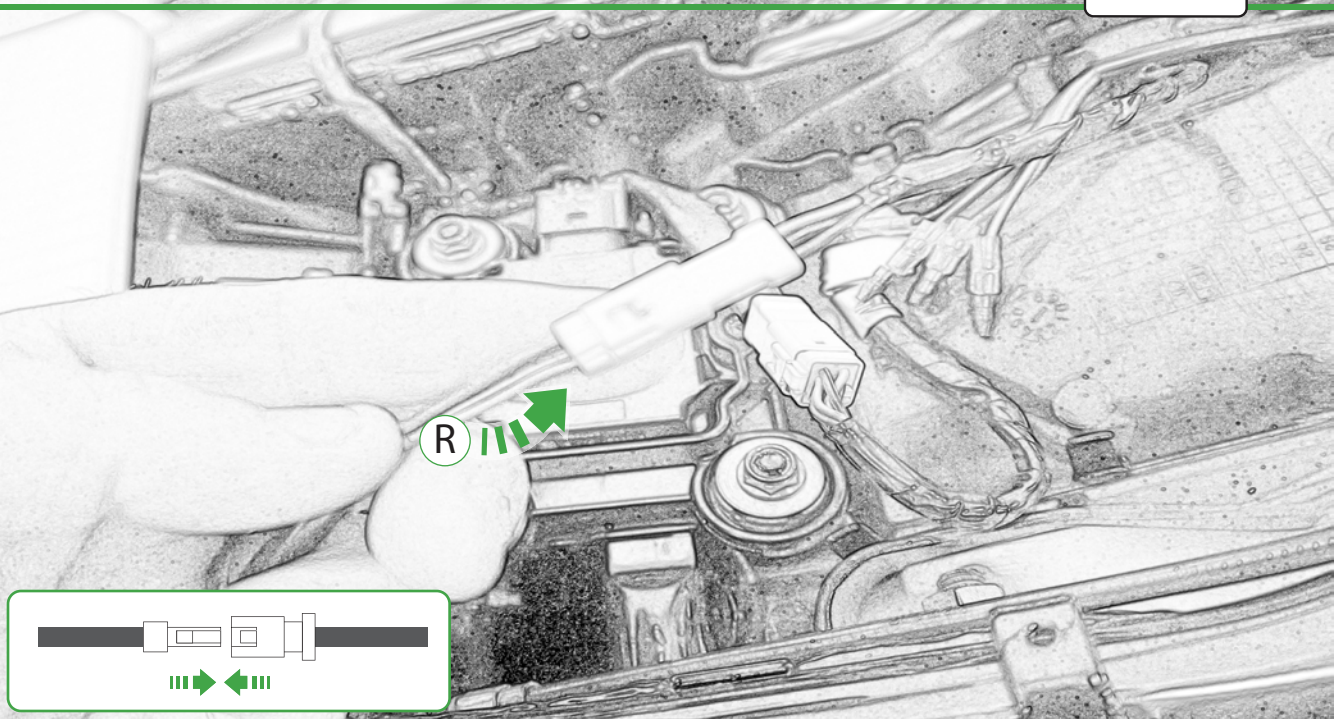

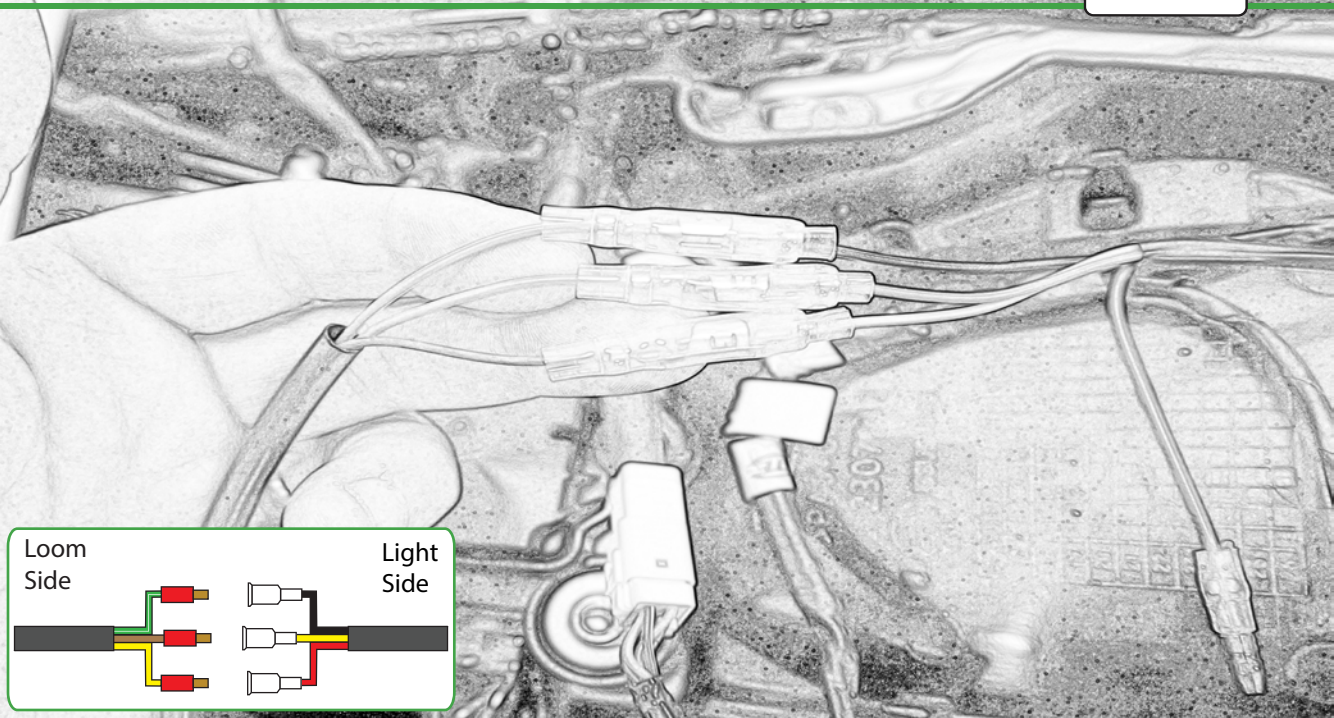

Loom
Side

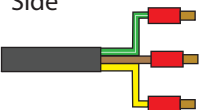

Light
Side

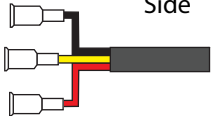



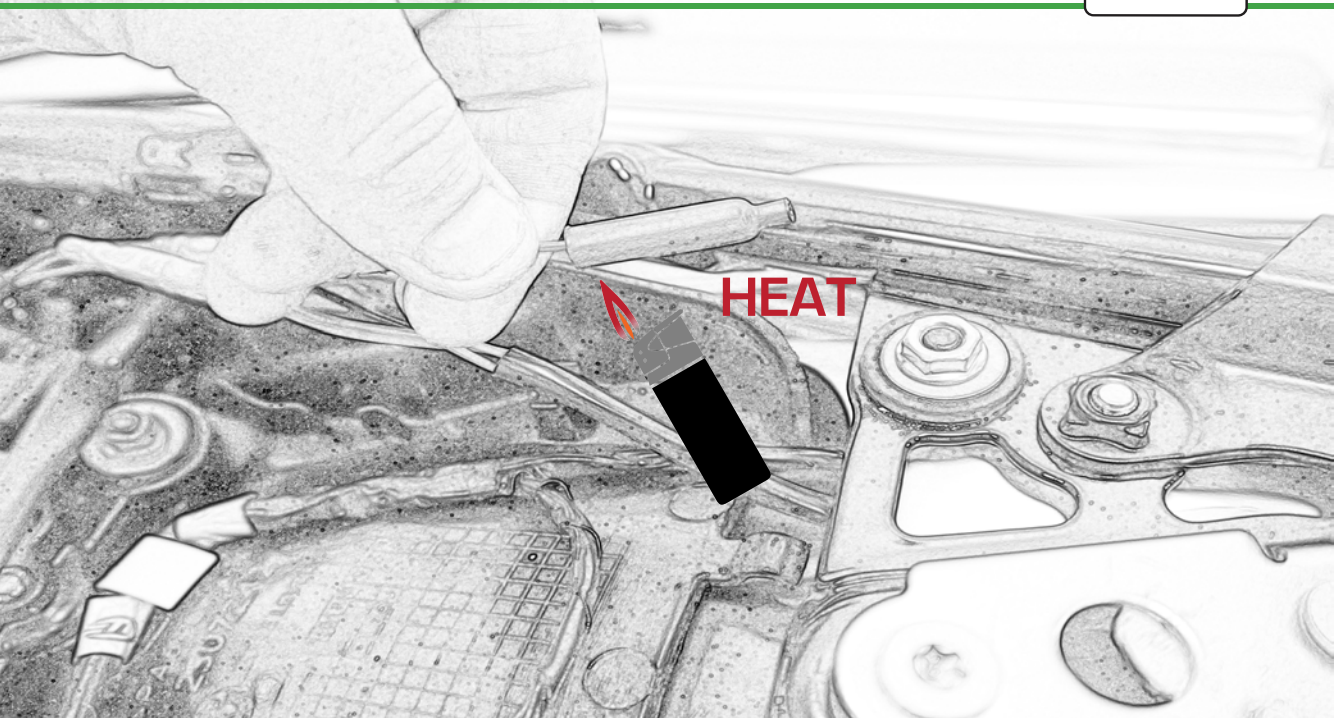

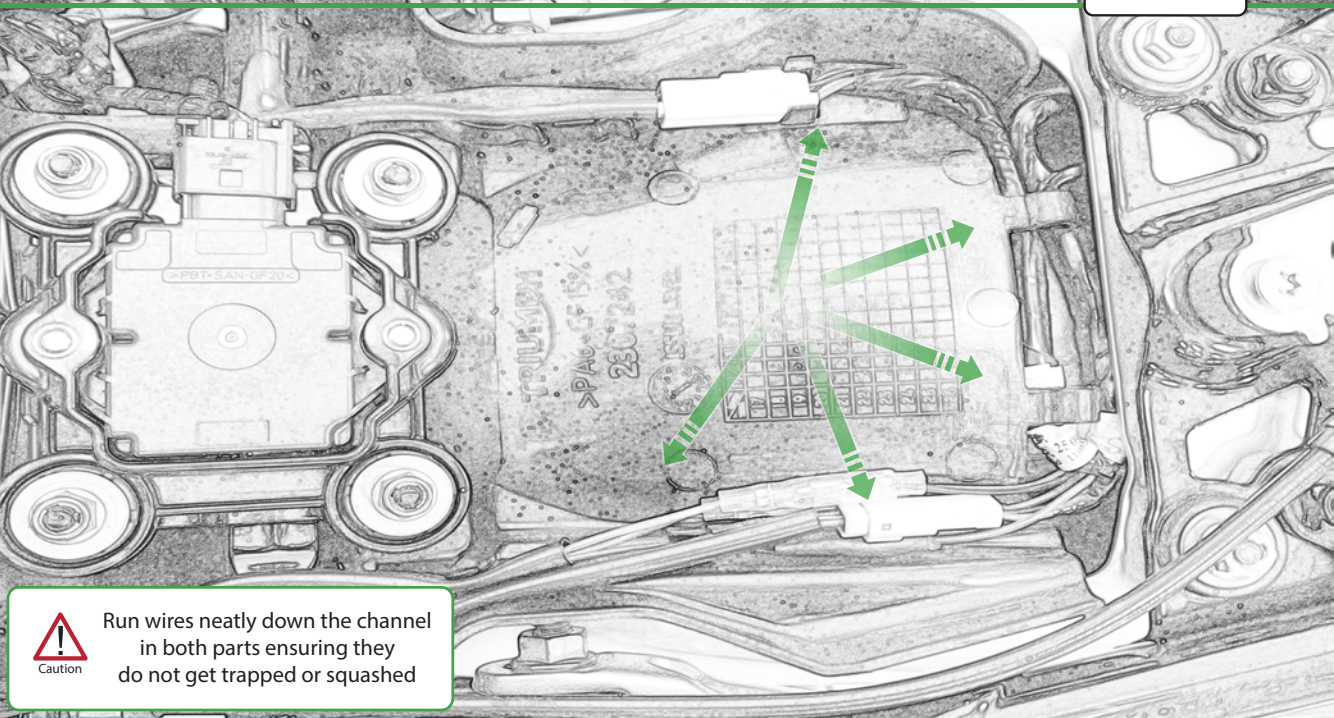

Run wires neatly down the channel
in both parts ensuring they
do not get trapped or squashed

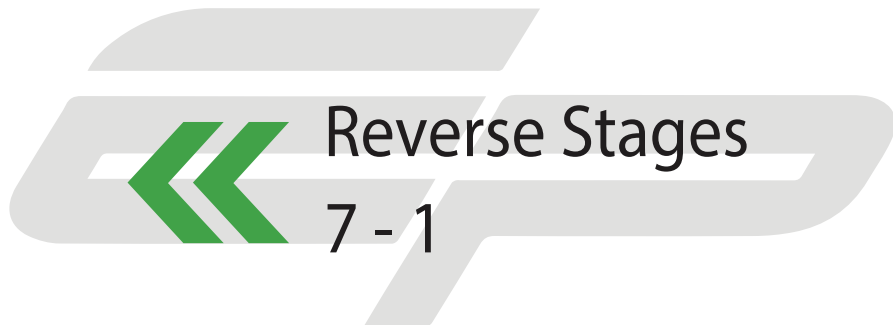



ESSENTIAL CHECKS



After installation of your tail tidy ensure that the licence plate does not contact the rear tyre when suspension is fully compressed.

Ensure all electrics including indicators, tail light, brake light and licence plate light lights are working correctly before riding the motorcycle.

It is recommended that periodic inspections are made to ensure that all fixings are fully tightend.

Installation Instructions

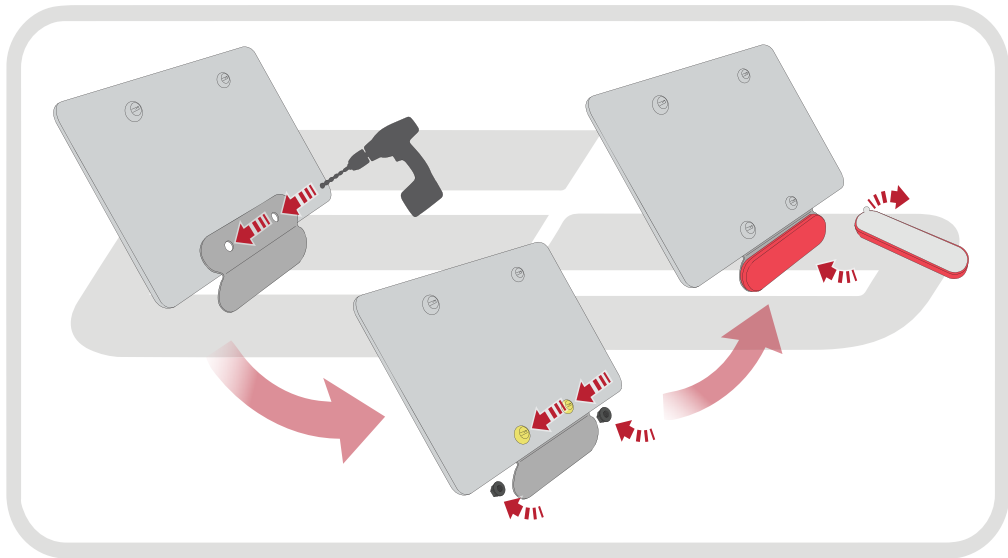

EVOTECH[®]
P E R F O R M A N C E

Installation Instructions

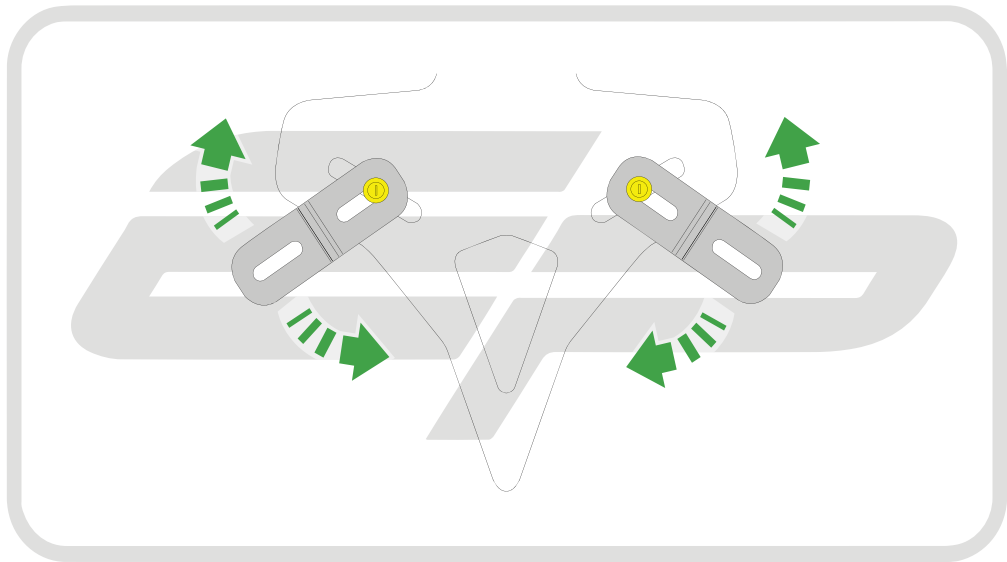

EVOTECH[®]
P E R F O R M A N C E



EVOTECH®
P E R F O R M A N C E

www.evotech-performance.com