

BIKE	YAMAHA YZF 1000 R1	PART NO.	EYA -59
YEAR	1998 - 2001	FIT KITS	OVAL Z039.11127 // ROUND Z039.10127
NOTES	Use standard fittings where not supplied <b>Remove standard gasket if fitted.</b>	DB-Killer	SCEXDBK12 - (Type B)

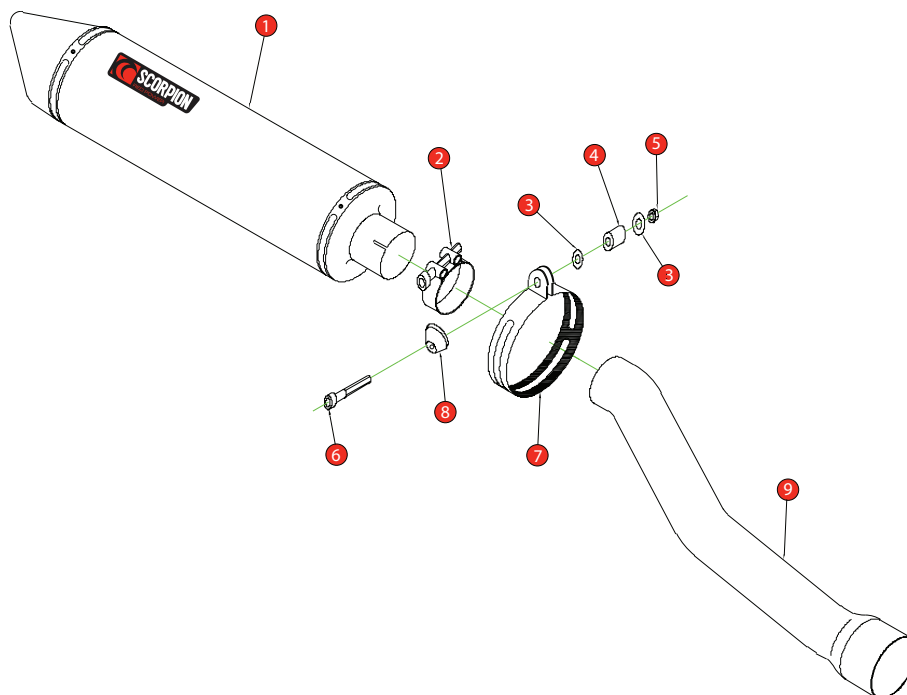

1 450mm Silencer ESC 50	8 Aluminium Bolt Finisher (Z026.20068)
2 51-55mm Band Clamp (Z016.10002)	9 Connecting Pipe CP 18
3 M8 x 25mm Washers (Z017.10825)	
4 10mm Aluminium Spacer (Z026.10004)	
5 M8 Nyloc Nut (Z017.10062)	
6 M8 x 60mm Cap Head Bolt (Z017.10080)	
7 Composite Silencer Strap (R-Z038.10090)(O-Z038.10088)	

E-MARK ROUND	<a href="#">SCDB-RS [e4] 2035</a>
E-MARK OVAL	<a href="#">SCDB-OS [e4] 2072</a>
ISSUE NO.	12
DATE	23/10/2018
AUTHORISED	J.Harkin
CHECKED	

**NOTE:** ENSURE SCORPION SYSTEM IS CLEAR OF MOVING PARTS AND ALL ORIGINAL FUNCTIONS WORK CORRECTLY.

A) Remove original exhaust from bike, taking care to keep all original components in a safe place.

B) Refit Scorpion exhaust as per line diagram above.

C) When fitted take bike for a short ride to ensure all functions are correct.

D) When bike & exhaust are cool enough check all nuts and bolts are still secure.